

Please Refer to File No.  
Form No. 2

## WELL RECORD

FILE WITH DEPUTY SUPERVISOR OF DISTRICT IN WHICH WELL IS LOCATED

Operator Phillips Petroleum Company Address Phillips Bldg., Bartlesville, Oklahoma  
County Galveston Survey S.F. Austin #3 Block No.        Subdivision "N"  
Lessor Stewart Title Guaranty Company Well No. 1 Elevation 82.5'  
(Above Sea Level)  
Drilling Commenced December 18, 1929 Drilling Completed March 17, 1930  
Correspondence regarding this well should be sent to: Name D. R. Knowlton Address Bartlesville, Oklahoma

SIZE	PUT IN WELL		PULLED OUT		LEFT IN WELL		PACKERS AND SHOES
	Ft.	In.	Ft.	In.	Ft.	In.	
10 3/4"	3057	3	13	9	3043	6	Trinity Special cement - Halliburton Float Equipment used.
7"	10,398	0	13	9	10,384	3	Trinity Inferno cement Baker whirler guide shoe and float collar.
2"	9243	9	13	9	9230	0	Mandrel - Pin collar

Initial Production of Gas—Volume No measurement Pressure OP 1840#, IP 1750#.

Initial Production of Oil: Barrels 6 barrels per hour 7/64" choke.

Remarks:

DESCRIPTION OF PROPERTY:  
NORTH

467' North, 467' West of the Southeast  
corner of Subdivision "N", S.F. Austin  
Survey #3, Galveston County, Texas.

GENERAL REMARKS

RECEIVED  
HOUSTON  
MAR 28 1930  
OIL & GAS DIVISION

SOUTH

RAILROAD COMMISSION OF TEXAS  
Oil and Gas Division

# FORMATION RECORD

SHOW ALL FORMATIONS, ESPECIALLY ALL SANDS AND CHARACTER AND CONTENTS THEREOF

FORMATIONS	TOP	BOTTOM	REMARKS
Surface	0	44	
Surface sand, clay & sand	44	639	
Shale & sand streaks	639	1060	
Shale & shells	1060	1880	
Sandy shale with strks			
sticky shale	1880	1700	
Sand & shale	1700	1875	
Shale, shells & sand streaks	1875	8708	
Sand	8708	2740	
Shale & shells	2740	3122	
Shale, shells & sand strks.	3122	3690	
Shale, shells & sand	3690	4069	
Shale & hard shells	4069	4194	
Hd sticky shale & shells	4194	4495	
Shale & hd shells	4495	4575	
Hard sand	4575	4621	
Shale & shells	4621	5040	
Hard shale & lime	5040	5540	
Hard lime	5540	5554	
Hd. lime & shells	5554	5658	
Hd lime & shale	5658	5845	
Shale	5845	5970	
Hard lime	5970	5976	
Hd lime & shale	5976	6018	
Shale & shells	6018	6321	
Shale & lime	6321	6403	
Shale and hd. lime	6403	6497	
Shale & lime	6497	6728	
Shale & hd lime	6728	6857	
Shale & shells	6857	7048	
Hard lime	7048	7050	
Hd. lime, strks of shale	7050	7102	
Shale	7102	7291	
Shale and lime strks.	7291	7684	
Shale & Hd. lime strks.	7684	7858	
Hd. lime & strks. shale	7858	7968	
Shale & lime	7968	7973	
Corrected measurement			
Hd. shale	7973	7986	
Shale	7986	8000	
Brittle shale, hd. sticky shale	8000	8008	
Shale	8008	8037	
Shale, strks. of hd. sand	8037	8047	
Shale, hd. sand strks.	8047	8057	
Shale & sandy shale	8057	8067	
Shale & hd sand	8067	8077	
Shale & hd sand	8077	8087	
Sandy shale	8087	8097	
Sandy shale & shale	8097	8107	
Sand & sandy shale	8107	8117	
Shale & sandy shale	8117	8127	
Hd. sandy shale & soft sand	8127	8137	
Shale	8137	8155	
Hd. sand	8155	8164	
Sandy shale & sand	8164	8175	
Hd. sand	8175	8185	
Sand	8185	8195	
Sand & brittle shale strks.	8195	8205	
Med. hd. sand & sandy shale	8205	8215	
Hd. stiky shale	8215	8225	
Sand	8225	8235	

Method of shutting off water. Is water completely shut off?  
 Amount of water with oil per cent

I, \_\_\_\_\_ being first duly sworn on oath state that I have knowledge of the facts and matter herein set forth and that the same are true and correct.

Representative of Company.

SHOW ALL FORMATIONS, ESPECIALLY ALL BANDS AND CHARACTER AND CONTENTS THEREOF

FORMATIONS	TOP	BOTTOM	REMARKS
Hard sand	8335	8357	
Hi. sand & shale	8337	8347	
Sand	8347	8377	
Sand & shale	8377	8387	
Shale	8387	8397	
Sand	8397	8407	
Shale & sand	8407	8417	
Sand	8417	8427	
Sand & shale	8427	8437	
Ringtail shale & hd. sand	8437	8452	
Hi. sandstone	8452	8463	
Sand	8463	8473	
Shale & sand, gray	8473	8483	
Sand & shale	8483	8493	
Hi. sand	8493	8498	
Sand	8498	8503	
Shale	8503	8513	
Sand	8513	8523	
Sandy shale	8523	8533	
Sand	8533	8543	
Hi. sandy shale	8543	8553	
Hi. sandy shale	8553	8563	
Hi. sand & shale	8563	8573	
Hi. sand & shale	8573	8583	
Hi. shale & sand	8583	8593	
Shale	8593	8603	
Shale & strks hd. sand	8603	8613	
Hi. shale	8613	8623	
Shale & sand	8623	8633	
Hi. sand	8633	8643	
Hi. sand	8643	8653	
Sand, odor	8653	8663	
Shale & sand	8663	8673	
Sand, hd. sand	8673	8683	
Shale & sand	8683	8693	
Hi. sandy shale & shale	8693	8703	
Hi. sandy shale	8703	8713	
Hi. shale & sand	8713	8723	
Hi. shale	8723	8733	
Hi. shale & sandy shale	8733	8743	
Shale & sand	8743	8753	
Bentonite	8753	8763	
Sand & shale	8763	8773	
Sandy shale	8773	8783	
Sand	8783	8793	
Corrected measurement from	8793 to 8859.7'		
Hi. shale & sand	8859	8905	
Sand & shale, slight odor	8905	8915	
Sand, shale, sand w/oil odor	8915	8918	
Sand & sandy shale (odor)	8918	8923	
Sand & shale	8923	8928	
Sand & shale	8928	8933	
Hi. shale	8933	8955	
Hi. sandy shale	8955	8969	
No recovery	8969	8980	
Hi. sand & sandy shale	8980	8993	
Hi. shale & sand	8993	9021	
Shale	9021	9023	
Sandy shale	9023	9025	
Sand	9025	9047	

Method of shutting off water ..... Is water completely shut off?  
Amount of water with oil ..... per cent

I, \_\_\_\_\_  
being first duly sworn on oath state that I have knowledge of the facts and matter herein set forth and that the same are true and correct.

Representative of Company.

# FORMATION RECORD

SHOW ALL FORMATIONS, ESPECIALLY ALL SANDS AND CHARACTER AND CONTENTS THEREOF

FORMATIONS	TOP	BOTTOM	REMARKS
No recovery	9047	9054	
Sand & shale	9054	9055	
No recovery	9055	9070	
Driftle shale & sand	9070	9080	
Sand & shale	9080	9091	
Sand	9091	9111	
Oil sand	9111	9121	
Sand	9121	9123	
Sand & shale	9123	9128	
Sandy shale, gray	9128	9133	
Hd. sand	9133	9138	
Hd. sand & sandy shale	9138	9143	
Sandy shale, slight odor	9143	9148	
Sand	9148	9153	
Sandy shale & shale	9153	9158	
Hd. shale & sand	9158	9168	
Sand & shale	9168	9178	
Shale	9178	9183	
Hd. shale & lime	9183	9230	
Shale & sand rock	9230	9235	
Hd. shale	9235	9242	
Brittle brown shale	9242	9252	
Ringtail shale & sand, gas odor	9252	9261	
Sand w/R.T. shale (gas odor)	9261	9269	
Shale w/hd. sand	9269	9274	Plugged hole from 9274' to 8715' with 290 sacks Incoro cement. Sidetracked W/Lane Wells knuckle Jt. after cement had set 72 hrs.
Hd. shale & sand	8715	8845	
Hd. sand	8845	8860	
Sand	8860	8867	
Sandy shale & shale	8867	8877	
Sand	8877	8885	
Sandy shale	8885	8887	
Sandy shale & sand	8887	8902	
Hd. shaly sand & lime strks.	8902	8929	
Hd. shale, strks. hd. sand	8929	8936	
Hd. shale & hd. strks. sand	8936	8957	
Hd. shaley sand	8957	8980	
Hd. sandy shale & hd. sand	8980	9011	
Sandy shale	9011	9020	
Shale	9020	9025	
Hd. shale	9025	9031	
Hd. sandy lime & shale strks.	9031	9055	
Hd. sandy shale	9055	9119	
Sandy shale & hd. sand strks.	9119	9164	
Hd. sandy lime	9164	9169	
Shale & sand	9169	9183	
Sticky shale	9183	9205	
Hd. shale	9205	9219	
Shale	9219	9232	
Hd. shale & lime	9232	9249	
Hd. sand	9249	9251	
Hd. shale	9251	9257	
Hd. sandy lime	9257	9260	
Hd. sand	9260	9275	
Sandy shale	9275	9285	
Hd. shale & sand	9285	9289	
Hd. shale	9289	9292	
Hd. sand & shale	9292	9302	
Hd. shale & sand	9302	9333	
Shale & sand strks.	9333	9338	
Hd. sandy shale	9338	9438	

Method of shutting off water

Is water completely shut off?

Amount of water with oil per cent

I,   
 hereby first duly sworn on oath state that I have knowledge of the facts and matter herein set forth and that the same are

SHOW ALL FORMATIONS, ESPECIALLY ALL SANDS AND CHARACTER AND CONTENTS THEREOF

FORMATIONS	TOP	BOTTOM	REMARKS
Hi. sandy shale	9488	9448	
Hi. shale	9448	9450	
Shale	9450	9453	
Hi. sandy lime	9453	9466	
Sandy shale, hard	9466	9488	
Sandy shale	9488	9498	
Shale & lime	9498	9516	
Hi. sandy shale & lime	9516	9591	
Hi. shale & sandy lime	9591	9623	
Brittle shale & gray sand	9623	9654	
Shale, hard sand streaks	9654	9680	
Shaly sand	9680	9666	
Sand	9666	9669	
Hi. shale and lime	9669	9694	
Sand rock	9694	9699	
Hard sandy lime rock	9699	9709	
Shale	9709	9728	
Hi. shale	9728	9746	
Shale & lime	9746	9758	
Hi. sand	9758	9770	
Hi. sand & shale	9770	9775	
Hard sand	9775	9785	
Hi. shale	9785	9800	
Sand	9800	9805	
Hi. shale	9805	9815	
Hi. sand & shale	9815	9817	
Shale & sand	9817	9821	
Sand	9821	9876	
Hi. shaly sand	9876	9915	
Hi. sand	9915	9937	
Shale	9937	9962	
Hard sandy shale	9962	9990	
Hi. sandy lime	9990	9998	
Hi. sand & lime	9998	10,004	
Hi. sandy shale	10,004	10,039	
Hi. sand	10,039	10,048	
Shale & sand	10,048	10,075	
Hi. sand & hi sandy shale	10,075	10,087	
Hi. shale and sandy lime	10,087	10,094	
Hi. sand	10,094	10,100	
Hi. shale & sand	10,100	10,114	
Hi. sand	10,114	10,141	
Hi. sandy shale	10,141	10,146	
Hi. sand	10,146	10,160	
Hi. shale & strks. Hi. sand	10,160	10,188	
Hi. shaly sand	10,188	10,241	
Hi. sandy shale	10,241	10,268	
Shale & sand	10,268	10,274	
Sand	10,274	10,278	
Sand & shale	10,278	10,297	
Hi. sandy lime	10,297	10,310	
Hi. sand	10,310	10,323	
Sand & shale	10,323	10,343	
Sand	10,343	10,368	
Hi. sand & strks of shale	10,368	10,387	
Hi. shale	10,387	10,400	
Original total depth		10,400	

Method of shutting off water. Cased off. Is water completely shut off? Yes  
 Amount of water with oil None per cent

I, P. O. Murphy  
 being first duly sworn, on oath state that I have knowledge of the facts and matter herein set forth and that the same are true and correct.

*P. O. Murphy* Division Superintendent  
 Representative of Company.

Subscribed and sworn to before me this 27th day of March, 1938



Please Refer to File No. ....

**FORM 1**  
**RAILROAD COMMISSION OF TEXAS—OIL AND GAS DIVISION**  
**Austin, Texas**

**IMPORTANT NOTICE:** This is the first record the RAILROAD COMMISSION has of any well. It is made the basis of all subsequent correspondence. Hence it must be correct.

**NOTICE OF INTENTION TO DRILL OR DEEPEN**  
**(USE FORM 2-A FOR NOTICE OF INTENTION TO PLUG)**

(To comply with Rules of the Railroad Commission of Texas governing Oil and Gas Conservation in Texas.)

**READ CAREFULLY AND COMPLY FULLY**

In order that it may be ascertained whether or not the proposed location covered by this notice conforms to the applicable spacing regulations set down by the Railroad Commission, there are two important footages that must be shown; that is, THE NEAREST DISTANCE OF PROPOSED LOCATION FROM LEASE OR PROPERTY LINE AND DISTANCE OF PROPOSED LOCATION FROM THE NEAREST WELL ON THE SAME LEASE. Do not begin operation on any location before filling Form 1, and do not begin operations on any location not conforming to the spacing rules for such location until you receive written order from the Commission granting permission.

For the purpose of this determination draw on the back side hereof a neat, accurate sketch, made to scale, of this lease, block, or lot locating thereon the proposed site for this location with reference to the two nearest lease lines. Also show the nearest wells on all sides of this location and the distances from the proposed location to those wells. Give names and addresses of adjoining lease or property owners, and designate all property by lease and company name. You may attach a blue print showing this information if you so desire.

**DO NOT CONFUSE SURVEY LINES WITH LEASE LINES. IF THE SKETCH OR BLUE PRINT SHOWS ONLY A SECTION, BLOCK, OR LOT OUT OF YOUR LEASE, DESIGNATE SAME AS BEING ONLY THAT PART OF THE LEASE.**

Where the size of the tract will permit, use scale of one inch equalling 400 feet; if less than 2 acres use scale of one inch equalling 100 feet. **DESIGNATE SCALE TO WHICH PLAT OR SKETCH IS DRAWN. ALSO DESIGNATE NORTHERLY DIRECTION ON THE SKETCH OR PLAT.**

\* \* \* \* \*

**FILL IN BELOW IN THE SPACES RESERVED FOR THIS PURPOSE THE FOOTAGES ASKED FOR:**

Nearest distance from proposed location to property or lease line..... **467'** .....feet.

Distance from proposed location to nearest drilling, completed, or applied for well on same lease..... **No others** .....feet.

\* \* \* \* \*

**DRAW SKETCH ABOVE REFERRED TO ON REVERSE SIDE HEREOF OR ATTACH TO THIS NOTICE A BLUE PRINT SHOWING THIS INFORMATION.**

This notice must be delivered to Deputy Supervisor of your district before drilling, or deepening. He will forward to the Railroad Commission, Austin, Texas.

Date..... **December 8** ....., 193**2** .....

Name of company or operator.....

Name..... **PHILLIPS PETROLEUM COMPANY** .....

Address..... **520 Espenson Building** .....

City..... **Houston, Texas** .....

Description of farm or lease:

Name (Fee owner)..... **Stewart Title and Guaranty Co.** .....

Number of Acres..... **278.2** ..... Well No..... **1** .....

Survey..... **S. F. Austin - League 3-A** .....

Subdivision..... **"N"** .....

Section..... **10** ..... Block No.....

Located in..... **League City** ..... Field

..... **Galveston** ..... County

..... **2.65** ..... Miles..... **S W** ..... direction from

..... **League City** ..... nearest postoffice or town.

Rotary or Cable Tools..... **Rotary** .....

Date work will start drilling..... **At once** .....

Depth to which you propose to drill..... **9200** .....feet.

Date work will start deepening.....

If Lease Purchased with one or more wells drilled From Whom Purchased..... **9** 193**8** .....

Name.....

Address.....

**Deliver to Deputy Supervisor in charge of district in which well is located.**

"Rule 37. Spacing Rule—(Applies to all fields in the State except where special field rules govern)—No well for oil or gas shall hereafter be drilled nearer than 300 feet to any other completed or drilling well on the same or adjoining tract or farm; and no well shall be drilled nearer than 150 feet to any property line, lease line, or sub-division line; provided that the Commission in order to prevent waste or to prevent the confiscation of property will grant exceptions to permit drilling within shorter distance than above proscribed whenever the Commission shall determine that such exceptions are necessary either to prevent waste or to prevent the confiscation of property. When an exception to such rule is desired, application therefor shall be filed with the Commission fully stating the facts, which application shall be accompanied by a plat drawn to the scale of one inch equalling 400 feet, accurately showing to scale the property on which permit is sought, to drill a well under an exception to this rule, and accurately showing to scale all other completed, drilling and permitted wells on said property; and accurately showing to scale all adjacent surrounding properties and wells. Such application shall be verified by some person acquainted with the

Phillips, George J.

1874

London

1874

Phillips, George J.

2

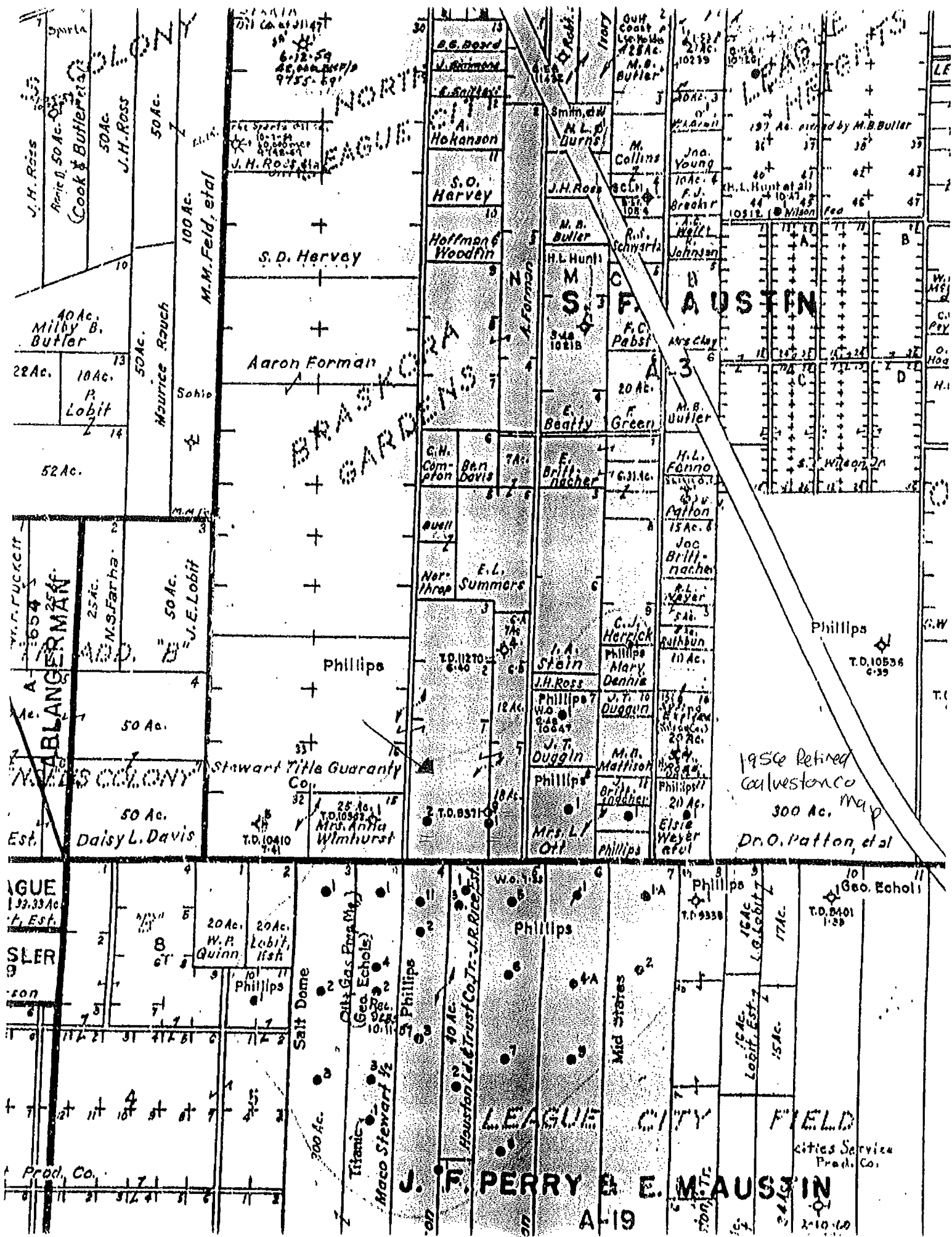

1956 Retired  
Galveston Co  
300 Ac. map  
Dr. O. Patton, et al

J. F. PERRY & E. M. AUSTIN  
A-19





# DATA ON WELL COMPLETION

"Notice of Intention to Drill" this well was filed in name of Phillips Petroleum Company  
 Date "Notice of Intention to Drill" was filed 12-8-38  
 Is location "REGULAR," or was "SPECIAL PERMIT" required? Regular  
 If special permit was secured what is permit number? -  
 Total number of acres in this lease 272.2  
 Number of crude oil producing wells on this lease in this field, including the well on which this potential was taken 2  
 Location of well, relative to lease boundaries of lease on which this well is located: 467 feet from South line and 487 feet from East line of the Stewart Title Guaranty lease.  
 Size of surface casing 10 3/4 Number feet of surface casing set 3043'6"  
 Size of oil string 7 Number of feet of oil string run 10,384'3"  
 Type of tubing head O.O.T. Type of Bradenhead O.O.T.  
 Top of pay 8670 Ft. Total Depth 9086 Ft. Size tubing run 2"  
 Perforated from 8672 to 8677 No. Shots 21 No. ft. tubing run 8635'  
 Kind of fuel used to drill this well Gas Amt. of fuel used Est. 68,250 MCF  
 Where fuel was secured Cron & Gracey's Dravant #1 and Fee #1, Dickinson Field,

## INSTRUCTIONS:

All potential test forms, WITH ALL INFORMATION REQUESTED THEREON FILLED IN, shall be filed in the District Office of the Railroad Commission not later than five (5) days after the test is completed and, should the operator fail to file potential test in an acceptable form within the five (5) days as specified then the effective date of the allowable resulting from such test shall not extend back more than five (5) days prior to receipt and acceptance of the potential test form in the office of the Deputy Supervisor. This five-day provision shall govern regardless of whether the potential test is taken during the month in which it is received in the office of the Deputy Supervisor or any prior month.

Any potential test form resulting from a retest of an oil well which is received in the district office of the Deputy Supervisor after the fifteenth (15th) of the month shall not be used as the basis for establishing a new allowable before the issuance of the proration schedule for the next succeeding month.

This test must be witnessed by either (1) a representative of the company making the test together with a representative of the Railroad Commission or (2) a representative of the company making the test, a representative of one offset operator, and the pipe line gauger for the pipe line running the oil from this well.

## EACH WITNESS MUST SIGN IN HIS OWN HANDWRITING.

We, the undersigned, witnessed this test and the top and bottom gauges of each tank into which production was run during duration of this test.

[Signature] Representative of Company making test  
[Signature] Representative of Offset Operator for None Offset Operator  
[Signature] Pipe Line Gauger for Pan American Pipe Line Company Pipe Line Company

Representative of the Railroad Commission

## AFFIDAVIT:

I HEREBY CERTIFY that all conditions prescribed by the Railroad Commission of Texas for this potential test were complied with and carried out in full, and that all data and facts set forth on both sides of this form are true and correct.

[Signature] Dist. Supt. for Phillips Petroleum Company  
 Representative of Company making test Company making test

SWORN TO AND SUBSCRIBED before me this the 19th day of August, 1944.

(Notary Seal)

Notary Public in and for Galveston County, Texas

REMARKS:

RECEIVED  
 AUG 22 1944  
 OIL & GAS DIVISION  
 TEXAS RAILROAD COMMISSION  
 HOUSTON, TEXAS

AUG 22 1944  
 OIL & GAS DIVISION  
 TEXAS RAILROAD COMMISSION  
 HOUSTON, TEXAS

RAILROAD COMMISSION OF TEXAS  
OIL AND GAS DIVISION

OIL AND GAS DOCKET NO. 128

#3-5766

IN RE: CONSERVATION AND PREVENTION OF  
WASTE OF CRUDE PETROLEUM AND NATURAL  
GAS IN THE LEAGUE CITY FIELD,  
GALVESTON COUNTY, TEXAS.

Austin, Texas  
January 4, 1944

SPECIAL ORDER GRANTING PHILLIPS PETROLEUM COMPANY  
PERMISSION TO DUALY COMPLETE ITS GUARANTY NO. 1  
OIL WELL IN THE LEAGUE CITY FIELD, GALVESTON COUNTY,  
TEXAS

WHEREAS, After due notice, the Railroad Commission of Texas held a hearing on September 29, 1943, to consider the application of Phillips Petroleum Company to dualy complete its Guaranty No. 1 well in the League City Field, Galveston County, Texas; and

WHEREAS: Pursuant to evidence adduced at said hearing, the Commission is of the opinion and finds that mechanical devices are available which are designed to permit the concurrent production of fluids from two different strata without commingling the fluids from the two separate strata within the bore of the well; and that said application should be granted as herein provided.

THEREFORE IT IS ORDERED By the Railroad Commission of Texas that, effective January 4, 1944, Phillips Petroleum Company be and it is hereby granted permission to dualy complete and produce its Guaranty No. 1 well in the League City Field, Galveston County, Texas in such manner that oil and gas is produced through the tubing from the Lobit Sand stratum between 9080 feet and 9126 feet, and that oil and gas is produced through the annular space between the tubing and casing from the 8700 Foot Sand stratum between 8678 feet and 8701 feet.

PROVIDED HOWEVER, That said well shall be completed and produced in such manner that there is no commingling within the bore of the well of fluids produced from any two separate strata encountered in said well.

PROVIDED FURTHER, However, that said well must be equipped in such manner that subsurface pressures may be determined on each of the two specified strata separately, and further that said well must be equipped with all necessary connections required to permit recording meters to be installed and used at any time so that when such meters are installed, all natural gas produced from each separate stratum may be accurately measured.

PROVIDED FURTHER, However, that the operator shall make any and all tests or determinations at such times and in such manner as is deemed reasonably necessary by the Commission Engineering Department.

PROVIDED FURTHER, However, that prior to the time said well is dualy completed that the operator shall supply the Commission Engineering Department for their approval, with a plat or drawing showing the proposed method and manner of completion, together with an electrical log showing the location and extent of each separate stratum and the proposed perforations; and that said proposed method and manner of dual completion shall not be approved unless it is deemed by the Commission Engineering Department that said proposed method and manner will effectively and absolutely prevent the movement or migration of fluids from one stratum to another.

SPECIAL ORDER GRANTING PHILLIPS PETROLEUM COMPANY  
PERMISSION TO DUALY COMPLETE ITS GUARANTY NO. 1  
OIL WELL IN THE LEAGUE CITY FIELD, GALVESTON COUNTY,  
TEXAS

WHEREAS, After due notice, the Railroad Commission of Texas held a hearing on September 29, 1943, to consider the application of Phillips Petroleum Company to dually complete its Guaranty No. 1 well in the League City Field, Galveston County, Texas; and

WHEREAS: Pursuant to evidence adduced at said hearing, the Commission is of the opinion and finds that mechanical devices are available which are designed to permit the concurrent production of fluids from two different strata without commingling the fluids from the two separate strata within the bore of the well; and that said application should be granted as herein provided.

THEREFORE IT IS ORDERED By the Railroad Commission of Texas that, effective January 4, 1944, Phillips Petroleum Company be and it is hereby granted permission to dually complete and produce its Guaranty No. 1 well in the League City Field, Galveston County, Texas in such manner that oil and gas is produced through the tubing from the Lobit Sand stratum between 9080 feet and 9126 feet, and that oil and gas is produced through the annular space between the tubing and casing from the 8700 Foot Sand stratum between 8678 feet and 8701 feet.

PROVIDED HOWEVER, That said well shall be completed and produced in such manner that there is no commingling within the bore of the well of fluids produced from any two separate strata encountered in said well.

PROVIDED FURTHER, However, that said well must be equipped in such manner that subsurface pressures may be determined on each of the two specified strata separately, and further that said well must be equipped with all necessary connections required to permit recording meters to be installed and used at any time so that when such meters are installed, all natural gas produced from each separate stratum may be accurately measured.

PROVIDED FURTHER, However, that the operator shall make any and all tests or determinations at such times and in such manner as is deemed reasonably necessary by the Commission Engineering Department.

PROVIDED FURTHER, However, that prior to the time said well is dually completed that the operator shall supply the Commission Engineering Department for their approval, with a plat or drawing showing the proposed method and manner of completion, together with an electrical log showing the location and extent of each separate stratum and the proposed perforations; and that said proposed method and manner of dual completion shall not be approved unless it is deemed by the Commission Engineering Department that said proposed method and manner will effectively and absolutely prevent the movement or migration of oil, gas or water from one stratum to another stratum.

IT IS FURTHER PROVIDED That the failure of the operator to comply with any provision or provisions of this order shall immediately terminate this order and all permission granted hereunder in its entirety.

IT IS FURTHER ORDERED That this Cause be held open on the docket for such other and further orders as may be necessary.

(SEAL)

ATTEST:

L. D. RANSOM, Secretary

RAILROAD COMMISSION OF TEXAS

Beauford H. Jester, Chairman

Ernest O. Thompson, Commissioner



POSITIVE CHECK

IX IN 3

IX IN 3

Top of 8678 Feet

NAME 8700 Foot Sand  
ON Completion Oil

Bottom of 8701 Feet

PERFORATED 8694-8696 Feet  
This zone produced  
through casing

Baker Production Packer  
Set at 9079 Feet

2 1/2" tubing landed at  
9083.35 Feet

Top of 9080 Feet

NAME 9080 Foot Sand  
ON Completion Oil

Bottom of 9120 Feet

PERFORATED 9099-9102 Feet  
This zone produced  
through casing

2 1/2" casing set at 10386 Feet  
10400 Feet

WELLS SERVICE COMPANY, EARTHSVILLE, OKLA.

WELL NO. 1  
WELL NO. 2

WELL NO. 1 SCALE 1/2" = 1' CONTRACTION NO. 1 (DRAWING NO.) C-142

RAU  
A

F. O. Brewer 188  
League City, Texas  
December 16, 1943

Mr. Bob Huff, Deputy Supervisor  
Railroad Commission of Texas  
Sterling Building  
Houston 2, Texas

Dear Sir:

In reply to your letter of December 7, 1943, we list the following information on our Guaranty No. 1 dual completion in the League City Field:

1. The electrical log which you mention in your letter was submitted at the State hearing for permission to dual complete this well and therefore is not attached to this letter.

(a) Guaranty No. 1-B (Upper Sand) was completed October 7, 1943, in the 8700' Sand.

Guaranty No. 1-A (Lower Sand) was completed November 23, 1943, in the 9100' or Lobit Sand.

(b) Upper and lower limits of the 8700' Sand - 8678' to 8701'.

Upper and lower limits of the 9100' Sand - 9030' to 9133'

(c) Upper Sand perforations - 8694' to 8696'.

Lower Sand perforations - 9099' to 9102'.

(d) Production Packer set between the two zones at 9079'.

2. Attached is a diagrammatic sketch of the mechanical installation which is employed to produce the well from both zones.

3. This well is a dual oil completion.

4. The Lower Sand is being produced through the tubing and the Upper Sand is being produced through the annular space.

As stated in your letter of December 7, 1943, this is the information required to permit you to enter a formal order relative to this dual completion.

Yours very truly,

*Hugh S. Graves*  
Hugh S. Graves, Dist. Supt.  
Phillips Petroleum Company

HSG:EP:b  
cc: Railroad Commission  
Austin, Texas

RESULT OF THIS POTENTIAL TEST (Bbls. of Crude oil per 24 hours) 215.19 (100% Tank Tbl.)  
GAS/OIL RATIO OF THIS WELL IS 557 Cubic ft. of gas per barrel of Crude Oil  
Gravity of oil produced during this test (Corrected to A.P.I. 60 degrees) 40.5



# DATA ON WELL COMPLETION

"Notice of Intention to Drill" this well was filed in name of Phillips Petroleum Company  
 Date "Notice of Intention to Drill" was filed 12-8-38  
 Is location "REGULAR," or was "SPECIAL PERMIT" required? Regular  
 If special permit was secured what is permit number? ---  
 Total number of acres in this lease 272.2  
 Number of crude oil producing wells on this lease in this field, including the well on which this potential was taken Three  
 Location of well, relative to lease boundaries of lease on which this well is located: 467 feet from South line and 467 feet from East line of the Stewart Title & Guaranty lease.  
 Size of surface casing 10-3/4" Number feet of surface casing set 3043'6"  
 Size of oil string 7" Number of feet of oil string run 10,384'3"  
 Type of tubing head O.O.T. Type of Bradenhead O.O.T.  
 Top of pay 9099 Ft. Total Depth 9220 FD Ft. Size tubing run 2"  
 Perforated from 9099 to 9102 No. Shots 13 No. ft. tubing run 9056'  
 Kind of fuel used to drill this well Gas Amt. of fuel used Est. 68,250 MCF  
 Where fuel was secured Cron & Gracey's Davant #1 and #2, Dickinson Field.

## INSTRUCTIONS:

All potential test forms, WITH ALL INFORMATION REQUESTED THEREON FILLED IN, shall be filed in the District Office of the Railroad Commission not later than five (5) days after the test is completed and, should the operator fail to file potential test in an acceptable form within the five (5) days as specified then the effective date of the allowable resulting from such test shall not extend back more than five (5) days prior to receipt and acceptance of the potential test form in the office of the Deputy Supervisor. This five-day provision shall govern regardless of whether the potential test is taken during the month in which it is received in the office of the Deputy Supervisor or any prior month.

Any potential test form resulting from a retest of an oil well which is received in the district office of the Deputy Supervisor after the fifteenth (15th) of the month shall not be used as the basis for establishing a new allowable before the issuance of the proration schedule for the next succeeding month.

This test must be witnessed by either (1) a representative of the company making the test together with a representative of the Railroad Commission or (2) a representative of the company making the test, a representative of one offset operator, and the pipe line gauger for the pipe line running the oil from this well.

## EACH WITNESS MUST SIGN IN HIS OWN HANDWRITING.

We, the undersigned, witnessed this test and the top and bottom gauges of each tank into which production was run during duration of this test.

Ray H. Smith Dist. Supt. for none  
 Representative of Company making test  
L. May for Pan American Pipe Line Company  
 Representative of Offset Operator  
 Pipe Line Gauger  
 Representative of the Railroad Commission

## AFFIDAVIT:

I HEREBY CERTIFY that all conditions prescribed by the Railroad Commission of Texas for this potential test were complied with and carried out in full, and that all data and facts set forth on both sides of this form are true and correct.

Ray H. Smith Dist. Supt. for Phillips Petroleum Company  
 Representative of Company making test  
 Company making test

SWORN TO AND SUBSCRIBED before me this the 3rd day of December, 19 43

(Notary Seal). R. F. Patterson R. F. Patterson

NOTARY PUBLIC in and for Galveston County, Texas.  
 REMARKS:

DEC 7-1943  
 RECEIVED



This form must be filed in District Office not later than five days after date of completion of test or penalty enforced.  
Do not take test for period of time less than specified by field rules.

RAILROAD COMMISSION OF TEXAS  
OIL AND GAS DIVISION

Date of Receipt  
in  
District Office

POTENTIAL TEST FORM

FURNISH ALL DATA IN FULL—DO NOT USE ESTIMATES  
(SEE INSTRUCTIONS ON REVERSE SIDE)

FIELD NAME: League City  
RAILROAD COMMISSION DISTRICT NUMBER: Three  
NAME OF OPERATOR: Phillips Petroleum Co. LEASE: Guaranty WELL NO.: 1-B  
ADDRESS: League City, Texas SECTION: A-3 BLOCK: 8/P-N  
P. O. BOX NO.: 188 SURVEY: S. F. Austin ELEVATION: 82.5  
COUNTY IN WHICH WELL IS LOCATED: Galveston Unit Designation: Ac. in Unit 272.8  
Date potential test commenced: November 30, 1943 Hour: 7:00 A.M.  
Date potential test completed: December 1, 1943 Hour: 7:00 A.M.  
Has this lease changed operating names within the last 60 days? No If so, what was the previous operating name?  
Has the Log of this well been filed with Deputy Supervisor? Yes Date Log filed: 8-30-39

DATA ON POTENTIAL TEST

Data Necessary on Flowing Well

Flowing pressure on csg.: 1375  
Flowing pressure on the dual completion: 1375  
Length of test: 24 Hrs. 7 Mins.  
Size choke: 1/8 Make choke: Positive  
Was this well flowed for the entire duration of this test without the use of swab or other artificial flowing device? Yes  
Is this well being jetted? No  
If being jetted, how many cubic feet of gas is being used to one barrel of oil recovered?  
Oil producing during this test into: Tank

Data Necessary on Pumping Well

Make of pumping unit: Ac. in Unit  
Length of stroke: 272.8  
No. strokes per minute: 272.8  
Is the working barrel: 272.8  
Length of test: 24 Hrs. 7 Mins.  
Was any oil produced from this well during this test lifted from the reservoir to the surface of the ground by the use of any device or means the use of which is not prescribed by the Railroad Commission in establishing potentials?

Name of P. L. Connection: pan American P. L. Co.  
If Shot: No Quarts used: No Gallons used: No  
Date this well was last shot or acidized: No  
Barrels of oil produced from this well since shot or treatment to time this test was started: No  
Barrels of oil produced from this well from its completion date or reworked completion date to beginning of this test: 2296 Per cent water produced during this test: None Total depth of this well: 9220 FT.  
Is this a test of a new well for which no previous allowable has been assigned? No  
Is this a plan retest (not a workover job) of a well which has a current allowable assigned? No  
What is the 24-hour potential at which it is carried currently on proration schedule? Not carried  
If this test is result of a workover what was the nature of the job? Dual completion  
Hour well completed: 7:00 A.M. Date well completed: October 7, 1943

TEST PRODUCTION DATA

(Furnish Tank Numbers, Size, Avg. Bbls. per Ft. and all Gauges in Ft. and In. and Bbls.)  
(Indicate marker in which production arrived at by placing result in proper column.)

TANK NO.	SIZE	BBLS. O PER FOOT	GAUGE				PRODUCTION COMPUTED			PRODUCTION 100% Tank Tally	PRODUCTION 100% Tank Tally
			Low	High	Low	High	Feet	In.	Bbls.		
6625	300	18.11	1	6	11	0	9	6	183.07	183.07	

RECEIVED

DEC 8 1943  
OIL & GAS DIVISION  
TEXAS RAILROAD COMMISSION  
HOUSTON, TEXAS

RESULT OF THIS POTENTIAL TEST (Bbls. of Crude oil per 24 hours) 183.07 (100% Tank Tbl.)  
GAS/OIL RATIO OF THIS WELL IS 605 Cubic ft. of gas per barrel of Crude Oil  
Gravity of oil produced during this test (Corrected to A.P.I. 60 degrees) 28.8

No. 1 B @ 12.4 gpc - 11/4/43 & 12/1/43

# DATA ON WELL COMPLETION

"Notice of Intention to Drill" this well was filed in name of Phillips Petroleum Company  
 Date "Notice of Intention to Drill" was filed 12-9-40  
 Is location "REGULAR," or was "SPECIAL PERMIT" required? Regular  
 If special permit was secured what is permit number? ---  
 Total number of acres in this lease 272.2  
 Number of crude oil producing wells on this lease in this field, including the well on which this potential was taken Three  
 Location of well, relative to lease boundaries of lease on which this well is located: 467 feet from South line and 467 feet from East line of the Stewart Title and Guaranty lease.  
 Size of surface casing 10-3/4" Number feet of surface casing set 3043'6"  
 Size of oil string 7" Number of feet of oil string run 10,384'3"  
 Type of tubing head O.O.T. Type of Bradenhead O.O.T.  
 Top of pay 8694 Ft. Total Depth 9220 FTD Ft. Size tubing run 2"  
 Perforated from 8694 to 8696 No. Shots 7 No. ft. tubing run 9056'  
 Kind of fuel used to drill this well Gas Amt. of fuel used Est. 68,250 MCF  
 Where fuel was secured Cron & Gracey's Davant #1 and Fee #1, Dickinson Field.

## INSTRUCTIONS:

All potential test forms, WITH ALL INFORMATION REQUESTED, THEREON FILLED IN, shall be filed in the District Office of the Railroad Commission not later than five (5) days after the test is completed and, should the operator fail to file potential test in an acceptable form within the five (5) days as specified then the effective date of the allowable resulting from such test shall not extend back more than five (5) days prior to receipt and acceptance of the potential test form in the office of the Deputy Supervisor. This five-day provision shall govern regardless of whether the potential test is taken during the month in which it is received in the office of the Deputy Supervisor or any prior month.

Any potential test form resulting from a retest of an oil well which is received in the district office of the Deputy Supervisor after the fifteenth (15th) of the month shall not be used as the basis for establishing a new allowable before the issuance of the proration schedule for the next succeeding month.

This test must be witnessed by either (1) a representative of the company making the test together with a representative of the Railroad Commission or (2) a representative of the company making the test, a representative of one offset operator, and the pipe line gauger for the pipe line running the oil from this well.

## EACH WITNESS MUST SIGN IN HIS OWN HANDWRITING.

We, the undersigned, witnessed this test and the top and bottom gauges of each tank into which production was run during duration of this test.

Hugh L. Smith Dist. Supt. for None  
 Representative of Company making test  
LeMay for Pan American Pipe Line Company  
 Representative of Offset Operator  
 Pipe Line Gauger

Representative of the Railroad Commission

## AFFIDAVIT:

I HEREBY CERTIFY that all conditions prescribed by the Railroad Commission of Texas for this potential test were complied with and carried out in full, and that all data and facts set forth on both sides of this form are true and correct.

Raymond H. Brown Dist. Supt. for Phillips Petroleum Company  
 Representative of Company making test

SWORN TO AND SUBSCRIBED before me this the 3rd day of December, 1940.

(Notary Seal)

R. F. Patterson R. F. Patterson  
 Notary Public in and for Galveston County, Texas.

## REMARKS:

EXCEL. TEST  
 TEXAS RAILROAD COMMISSION  
 C. R. & C. S. DIVISION

DEC 11 - 1940

RECEIVED

# RAILROAD COMMISSION OF TEXAS OIL AND GAS DIVISION

Form 3  
Well Record

File No. \_\_\_\_\_  
Operator Phillips Petroleum Company Address Bartholomew, Oklahoma  
County Calvin Survey S. & A. Austin Block No. \_\_\_\_\_ Sec. No. A-3  
Lease Name Quarant Well No. 2 Elevation \_\_\_\_\_ (above sea level)  
Name of Field in which well is located League City

Form 1 (Notice of Intention to Drill) Was Filed in Name of Phillips Petroleum Company

Drilling Commenced December 16, 1939 Drilling Completed March 17, 1940

Is this a NEW WELL? No DEEPENING? No WORK-OVER? Plug Back

Correspondence regarding this well should be sent to: Name Ralph L. Young Address Alvin, Texas

Has an allowable been assigned to this well? No

SIZE	PUT IN WELL		PULLED OUT		LEFT IN WELL		PACKERS AND SHOES
	Pl.	In.	Pl.	In.	Pl.	In.	
<u>10-3/4</u>	<u>3043</u>	<u>6</u>	<u>"</u>	<u>"</u>	<u>3043</u>	<u>6</u>	<u>Halliburton Float Equipment</u>
<u>7</u>	<u>10384</u>	<u>3</u>	<u>"</u>	<u>"</u>	<u>10384</u>	<u>3</u>	<u>Baker Float Collar</u>

Initial Production of Gas—Volume 1805 MCF 24 hrs. Pressure 2210 lbs. per square inch

Initial Production of Oil: Barrels \_\_\_\_\_

Initial Production of Distillate: Barrels 45.54

Is this an Oil well? No a GAS well? Yes or a Dry HOLE? No

DESCRIPTION OF PROPERTY  
NORTH

GENERAL REMARKS

Plugged back to 9013.36'. Perforated  
8916' - 37' with 84 shots. Ran Baker  
packer set at 8820'. Set 2-3/8" tubing  
at 8738.49' and exhibited well in.

POST

RECEIVED TO THE  
COMMISSIONER OF THE OIL AND GAS DIVISION  
RAILROAD COMMISSION OF TEXAS

SOUTH

FILE IN DUPLICATE WITH DEPUTY SUPERVISOR OF DISTRICT IN WHICH WELL IS LOCATED

**FORMATION RECORD**  
 Show All Formations, Depths, All Shales and Chert and Change Thereof

FORMATION	TOP	BOTTOM	REMARKS
Barren sand and clay	0	639	
Sandy shale w/shells	639	2703	
Sand	2703	2760	
Sandy shale & ed strks	2760	4573	
Hard sand	4573	4621	
Shale and lime	4621	7973	
Sandy shale	7973	8135	
Sand	8135	8146	
Shale	8146	8178	
Sand w/shale stringer	8178	8302	
Shale w/sand strks	8302	8360	
Sand w/shale strks	8360	8416	
Sandy shale	8416	8437	
Sand	8437	8479	
Shale	8479	8673	
Sand	8673	8692	
Shale	8692	8729	
Sand	8729	8742	
Shale	8742	8834	
Shaly sand	8834	8864	
Shale	8864	8914	
Shaly sand	8914	8940	
Shale	8940	8967	
Sand & shale	8967	8991	
Shale	8991	9034	
Sand	9034	9044	
Sandy shale	9044	9080	
Sand w/shale strks	9080	9179	
Shale	9179	9229	
Sand w/shale strks	9229	9282	
Shale	9282	9308	
Sand w/shale strks	9308	9442	
Shale	9442	9468	
Sand w/shale strks	9468	9578	
Shale	9578	9605	
Shaly sand	9605	9641	
Sandy shale	9641	9666	
Sand	9666	9682	
Shale	9682	9760	
Sand & shale stringers	9760	9824	
Sand w/shale strks	9824	9964	
Shale	9964	10007	
Sand w/shale strks	10007	10091	
Shale	10091	10116	
Sand w/shale strks	10116	10239	
Shale	10239	10247	
Sand w/shale strks	10247	10389	

Method of shutting off water. Cased off

Amount of water with oil

None

Is water com

per cent

I, John S. Young

belong to the State of Texas and that I have knowledge of the facts and matters herein set forth and that the same are true and correct.

Subscribed and sworn to before me this 14th day of July 1954

**RECEIVED**

**RECEIVED**

Oil & Gas Division  
 TEXAS RAILROAD COMMISSION  
 DALLAS, TEXAS

Brasoria

Notary Public  
 County, Texas



RESULT OF THIS POTENTIAL TEST (Bbls. of Crude oil per 24 hours) 255.43 (100% Tank Tbl.)  
GAS/OIL RATIO OF THIS WELL IS 1042 Cubic ft. of gas per barrel of Crude Oil  
Gravity of oil produced during this test (Corrected to A.P.I. 60 degrees) 41.20

# DATA ON WELL COMPLETION

"Notice of Intention to Drill" this well was filed in name of Phillips Petroleum Company  
 Date "Notice of Intention to Drill" was filed December 8, 1938  
 Is location "REGULAR," or was "SPECIAL PERMIT" required? Regular Location  
 If special permit was secured what is permit number? -  
 Total number of acres in this lease 272.2  
 Number of crude oil producing wells on this lease in this field, including the well on which this potential was taken 0M  
 Location of well, relative to lease boundaries of lease on which this well is located: 467 feet from South line and 467 feet from East line of the Stewart Title & Guaranty lease.  
 Size of surface casing 10 5/8" Number feet of surface casing set 3043'0"  
 Size of oil string 7" Number of feet of oil string run 10,384'3"  
 Type of tubing head O.C.T. Type of Bradenhead O.C.T.  
 Top of pay 9245 Ft. Total Depth 10,400 Ft. Size tubing run 2"  
 No. ft. tubing run 9256  
 Kind of fuel used to drill this well Gas Amt. of fuel used 68,250 M.C.F. Estimated  
 Where fuel was secured Oron and Gracey's - Davant #1 and Yee #1 - Dickinson Field  
 Name and address of contractor Glen H. McCarthy - Houston, Texas

## INSTRUCTIONS:

All potential test forms, WITH ALL INFORMATION REQUESTED THEREON FILLED IN, shall be filled in the District Office of the Railroad Commission not later than five (5) days after the test is completed and, should the operator fail to file potential test in an acceptable form within the five (5) days as specified then the effective date of the allowable resulting from such test shall not extend back more than five (5) days prior to receipt and acceptance of the potential test form in the office of the Deputy Supervisor. This five-day provision shall govern regardless of whether the potential test is taken during the month in which it is received in the office of the Deputy Supervisor or any prior month.

Any potential test form resulting from a retest of an oil well which is received in the district office of the Deputy Supervisor after the fifteenth (15th) of the month shall not be used as the basis for establishing a new allowable before the issuance of the proration schedule for the next succeeding month.

This test must be witnessed by either (1) a representative of the company making the test together with a representative of the Railroad Commission or (2) a representative of the company making the test, a representative of one offset operator, and the pipe line gauger for the pipe line running the oil from this well.

## EACH WITNESS MUST SIGN IN HIS OWN HANDWRITING.

We, the undersigned, witnessed this test and the top and bottom gauges of each tank into which production was run during duration of this test.

M.R.M. Arthur Representative of Company making test for Midstates Oil Corp.  
Ray Youngblood Representative of Offset Operator Offset Operator  
Smith & Smith Pipe Line Gauger for Pan-American Pipe Line Company

Representative of the Railroad Commission \_\_\_\_\_

## AFFIDAVIT:

I HEREBY CERTIFY that all conditions prescribed by the Railroad Commission of Texas for this potential test were complied with and carried out in full, and that all data and facts set forth on both sides of this form are true and correct.

M.R.M. Arthur for Phillips Petroleum Company  
 Representative of Company making test Company making test

SWORN TO AND SUBSCRIBED before me this the 30th day of March, 1938

(Notary Seal)

Notary Public in and for Harris County, Texas.

## REMARKS:

11:42:25 Monday, August 12, 2013

\*\*\* OIL AND GAS DIVISION \*\*\*  
WELL BORE TECHNICAL DATA MENU

KEY INFORMATION FOR ONE OF THE FOLLOWING:

OIL: DIST: \_\_\_\_\_ LEASE: \_\_\_\_\_ WELL #: \_\_\_\_\_ (OPTIONAL - LEAVE  
GAS: RRC ID: \_\_\_\_\_ WELL # BLANK FOR  
DRILL PERMIT: \_\_\_\_\_ LIST OF WELLS.)  
API NUMBER: 167 01813

PLACE AN 'S' BY TYPE OF TRANSACTION:

S INQUIRY \_ ADD \_ CHANGE \_ DELETE (SIGN ON TO ADD/CHG/DELETE)

PLACE AN 'S' BY THE DESIRED ITEM:

S W-2/G-1 RECORD:	PLUGGING DATA:	PERMITS / WELL IDS
CASING/LINER/TUBING/PERFS	PLUG RECORD	LOCATION DATA
SQUEEZE/FORMATION	CASING/TUBING/PERFS	NOMENCLATURE
REMARKS	DRY HOLE WATER DEPTHS	H-15 DATA
USABLE WATER DEPTHS	LOGS,REMARKS	API#/WB DATA
ORPHAN WELL HOLD	DIST W3 APPR DATE	API#/WB14B2

NAME CROSS REFERENCE: LEASE NAME: \_\_\_\_\_  
OPER NAME: \_\_\_\_\_  
OPER NUMBER: \_\_\_\_\_

\* OPTION : \_\_\_\_\_ (00=HELP, 01=MAIN MENU, 06=DRILL PERMIT MENU, 40=WB 14B2 INQ)  
API NUMBER IS NOT ON FILE



42167018130000

**General Information**

I-A STEWART TITLE GTY

Data Source:	PI	IC:	
API:	42167018130000	County:	GALVESTON
State:	TEXAS	Operator:	PHILLIPS PETRLM CO
Field:	LEAGUE CITY	Current Operator:	PHILLIPS PETROLEUM COMPANY
Current Status:	P	Final Well Class:	DEVELOPMENT WELL-OIL ( DO )
Initial Class:	DEVELOPMENT WELL ( D )	Target Objective:	
Status:	OIL		
Permit:	on Dec 06, 1935	Hole Direction:	VERTICAL
		First Report Date:	Feb 15, 1980
		Abandonment Date:	
Projected TD:		Projected Formation:	
Geologic Province:	GULF COAST BASIN	Formation at TD:	UNKNOWN
Play Name:		Play Type:	
IP Summary:			
Oil:	235 BBL	Gas:	
		Water:	
		Top Form:	

**Location**

Footage NS EW Origin:		Data Source:	PI
Dist, Abs, Survey:	RR DISTRICT 03 3	S F AUSTIN	
Blk, Lge, Lot, Labor:			
Township, Section:			
Lat/Long:	+29.4696189 -95.1115024	Lat/Long Source:	IH
		Datum:	NAD27

**Location Narrative**

Data Source	Type	Remark
PI	LOCATION	467 OUT OF SE/COR OF LOT #7 BEING 1782 ACRE TRACT

**Dates and Depths**

Data Source:	PI		
Spud:	Dec 16, 1935	Spud Date Code:	
TD:	10,400 FT	TD Date:	
TVD:		PlugBack Depth:	
Formation Code TD:	000UNKWN	Formation Name TD:	UNKNOWN Ref. Elevation: 34
FT DF KB. Elevation:			
Ground Elevation:	23 FT GR	LTD:	
Contractor:			
Completed:	Apr 03, 1939	Final Drilling:	
Rig Release Date:		Rig #:	
Tool:			

**Initial Potential Tests**

IP: 001	Data Source: PI		
Top Formation Name:		Top Formation Code:	
Base Formation Name:		Base Formation Code:	
Oil:	235 BBL	Condensate:	
Gas:		Water:	
Interval:	9,250 - 9,256	Method: UNDESIGNATED	
		Duration of Test:	
41.8 API GOR:	1042 CFB	24 Hours Choke:	08/64
Cond Gravity:		Oil Gravity:	
Cond Ratio:			



## Pressures

Test	Data Source	FTP	FCP	SITP	SICP
001	PI	1,820 PSIG	1,850 PSIG		

## Oil Analysis

Test	Data Source	GOR	Interval	Top Form	Name
001	PI	1042	9250 - 9256		

## Perforations

Test	Data Source	Interval	Count	Type	Status	Shots/ Ft	Prod Method	Top Form Code	Top Form Name
001	PI	9250 - 9256	24				PERF		

## Production Tests

PT: 001

Data Source:	PI	Top Formation Code:	
Top Formation Name:		Base Formation Code:	
Base Formation Name:		Condensate:	
Oil:	UO	Water:	
Gas:		Method:	FLOWING
Interval:	9,250 - 9,256	Choke:	08/64
Duration of Test:	Hours	GOR:	
Oil Gravity:		Cond Ratio:	
Cond Gravity:		Main Fluid Code:	
Prod Method:	PERF		

## Pressures

Test	Data Source	FTP	FCP	SITP	SICP
001	PI	1,400 PSIG	1,200 PSIG		

## Perforations

Test	Data Source	Interval	Count	Type	Status	Shots/ Ft	Prod Method	Top Form Code	Top Form Name
001	PI	9250 - 9256	24				PERF		

## Cores

CORE ID: 001

Formation:	Data Source: PI	Interval:	8063-8065 Rec:	Show Type: ODOR
Core Type:				
Description:	SS OO			

CORE ID: 002

Formation:	Data Source: PI	Interval:	8065-8069 Rec:	Show Type: ODOR
Core Type:				
Description:	SH SDY OO			

CORE ID: 003

Formation:	Data Source: PI	Interval:	8087-8089 Rec:	Show Type: ODOR
Core Type:				
Description:	SH SDY OO			

CORE ID: 004

Formation:		Data Source: PI	
Interval:	8905-8913	Rec: 4.5 FT	
Core Type:	CONV	Show Type: ODOR	

# Scout Ticket

Mon Aug 12, 2013

Description:	* 4.5TSH SDY OO		
CORE ID: 005			
Formation:		Data Source: PI	
Interval:	8918-8928	Rec: 7 FT	
Core Type:	CONV	Show Type: ODOR	
Description:	* 7 TSS OO		
CORE ID: 006			
Formation:	Data Source: PI Interval: 9035-9047 Rec:	Core Type:	Show Type:
Description:	SS SHOWING OIL		
CORE ID: 007			
Formation:		Data Source: PI	
Interval:	9070-9080	Rec: 8.6 FT	
Core Type:	CONV	Show Type: OIL	
Description:	* 1.5TSH		
	* 7 TSS OIL		
CORE ID: 008			
Formation:		Data Source: PI	
Interval:	8675-8692	Rec: 12 FT	
Core Type:	CONV	Show Type: ODOR	
Description:	* 12 TSS & SDY SH OO		
CORE ID: 009			
Formation:	Data Source: PI Interval: 8885-8895 Rec:		
Core Type:		Show Type: ODOR	
Description:	SH OO		
CORE ID: 010			
Formation:	Data Source: PI Interval: 9090-9106 Rec:		
Core Type:		Show Type: ODOR	
Description:	SH SDY OO		
CORE ID: 011			
Formation:	Data Source: PI Interval: 9106-9116 Rec:		
Core Type:		Show Type: OIL	
Description:	SS OIL SHOW		
CORE ID: 012			
Formation:	Data Source: PI Interval: 9118-9127 Rec:		
Core Type:		Show Type: WET	
Description:	SS SW		
CORE ID: 013			
Formation:	Data Source: PI Interval: 9252-9261 Rec:		
Core Type:		Show Type: ODOR	
Description:	SS OO		
CORE ID: 014			
Formation:	Data Source: PI Interval: 9650-9666 Rec:		
Core Type:		Show Type: ODOR	
Description:	SH SDY OO		
CORE ID: 015			
Formation:	Data Source: PI Interval: 9775-9785 Rec:		

# Scout Ticket

Mon Aug 12, 2013

Core Type:					Show Type: ODOR
Description:	SH SDY OO				
CORE ID: 016					
Formation:	Data Source: PI	Interval:	9823-9843	Rec:	
Core Type:					Show Type: GAS
Description:	SS GAS				
CORE ID: 017					
Formation:	Data Source: PI	Interval:	9843-9850	Rec:	
Core Type:					Show Type: OIL
Description:	SS OIL SHOW				
CORE ID: 018					
Formation:	Data Source: PI	Interval:	9850-9860	Rec:	
Core Type:					Show Type: WET
Description:	SS SALT WATER				
CORE ID: 019					
Formation:	Data Source: PI	Interval:	10040-10065	Rec:	
Core Type:					Show Type: ODOR
Description:	SH SDY OO				
CORE ID: 020					
Formation:	Data Source: PI	Interval:	10074-10093	Rec:	
Core Type:					Show Type: WET
Description:	SS SALT WATER				
CORE ID: 021					
Formation:	Data Source: PI	Interval:	10118-10138	Rec:	
Core Type:					Show Type: WET
Description:	SS SALT WATER				
CORE ID: 022					
Formation:	Data Source: PI	Interval:	10146-10160	Rec:	
Core Type:					Show Type: WET
Description:	SS SALT WATER				
CORE ID: 023					
Formation:	Data Source: PI	Interval:	10313-10323	Rec:	
Core Type:					Show Type: OIL
Description:	SS OS				

Casing, Liner, Tubing				
Casing	Data Source	Size	Base Depth	Cement
CASING	PI	10 3/4 IN	3,043 FT	
CASING	PI	7 IN	10,398 FT	
Tubing	Data Source	Size	Mixed String	Base Depth
TUBING	PI	2 IN		9,246 FT

Drilling Journal						
Logs						
Log	Source	Type	Top Depth	Base Depth	Logging Co.	BHT
1	PI	IL	0	10,400	153789	since circ.

Please Refer to  
File No. \_\_\_\_\_

RAILROAD COMMISSION OF TEXAS  
OIL AND GAS DIVISION

Form 4.  
Plugging Record

FILE IN DUPLICATE WITH DEPUTY SUPERVISOR OF DISTRICT IN WHICH WELL IS LOCATED

Company Phillips Petroleum Company Address Bartlesville, Oklahoma  
Sec. No. S/D - N Block No. \_\_\_\_\_ Survey S.F. Austin, Lgs. 3-4 County Galveston  
Well No. 1 Name of Lease "Stewart Title and Guaranty Co." (Guaranty) No. of Acres 30  
Name of Field in which well is located League City Date well was plugged Oct. 26, 1959  
Form 1 (Notice of Intention to Drill) was filed in Name of Phillips Petroleum Company  
Character of Well at the time of completion: Oil 235 bbls; Gas 245 Cu. Ft.; Dry \_\_\_\_\_  
(Initial Production) (Initial Production)  
Amount well producing when plugged: Oil 5 bbls; Gas None Cu. Ft.; Water 417 bbls.  
Has this well ever produced oil or gas? Yes  
Total Depth PTD - 9013.36 ft. Top of each producing sand None feet.  
Was the well filled with mud-laden fluid, according to regulations of the Railroad Commission? Yes

How was mud applied? Pumped thru tubing

Were plugs used? Yes (Cement). If so, show all shoulders left for casing, depth of each, and size of casing, size and kind of plugs used, and depth placed. Also amount of cement and rock. Was well shot? No

Laid plug from 8820' to 8371'. Laid plug from 2460' to 2273'.

Laid 12' cement plug in top of 10-3/4" casing.

SIZE PIPE	PUT IN WELL		PULLED OUT		LEFT IN WELL		PACKERS AND SHOES
	Ft.	In.	Ft.	In.	Ft.	In.	
10-3/4"	3043	50	-	-	3043	50	Halliburton (100 ex Stargor cmt.)
7"	10384	25	2391	98	7992	27	Halliburton (70 ex Lonestar cmt.)

Show depth found and thickness of all water, oil and gas formations See Log dated July 14, 1954.

Have all abandoned wells on this lease been plugged according to Commission's rules? Yes

Manner of confining all oil, gas or water to strata: As shown above

The names of adjacent leases, royalty and landowners with their addresses in each instance as follows:

All adjoining leases owned by Phillips Petroleum Company

Was notice given before plugging to all available adjacent lease owners as required by Rule 10? Yes

I, Ralph L. Young, being first duly sworn on oath, state that I have knowledge of the facts and the matter herein set forth and that the same are true and correct.

Subscribed and sworn to before me this

NOV - 2 1959

Railroad Commission of Texas  
OIL & GAS DIVISION

Correspondence regarding this well should be addressed to:

Name Ralph L. Young

Address P.O. Box 272, Alvin, Texas

Name Ralph L. Young Title Dist. Supt.

30th day of October, 19 59

Notary Public Braxton County, Texas



Please refer  
to File No. \_\_\_\_\_

RAILROAD COMMISSION OF TEXAS  
OIL AND GAS DIVISION

Form 2A  
Application  
To Plug and  
Well Record

FILE IN DUPLICATE WITH DEPUTY SUPERVISOR OF DISTRICT IN WHICH  
WELL IS LOCATED FIVE FULL DAYS PRIOR TO PLUGGING

Company Phillips Petroleum Company Address Bartlesville, Oklahoma  
Sec. No. S/D - N Block No. - Survey S.F. Austin, Lge. 3-A County Galveston  
Well No. 1 Name of Lease "Stewart Title and Guaranty Co." No. of Acres 30 Elev. 23'  
Name of Field in which well is located League City  
Located 2.65 Miles S.W. Direction from League City, Texas (Nearest P. O. or Town)  
Form 1, "Notice of Intention to Drill," was filed in name of Phillips Petroleum Company  
Drilling Commenced December 16, 19 38, Drilling Completed March 17, 19 39  
Has this well ever produced Oil? Yes or Gas? Yes  
Character of Well (Oil, Gas or Dry) Gas Total Depth PTD - 9013.36'  
Date you wish to Plug October 26, 19 59.  
Name of Party Plugging Well Fred Hints, Oil Well Service Address P.O. Box 1192, Dickinson, Texas  
Correspondence regarding this well should be sent to: Name Ralph L. Young  
Address P.O. Box 272, Alvin, Texas  
Initial Production of Gas: Volume (MCF) 245 24 hrs. Pressure 1840 lbs. per square inch  
Initial Production of Oil: Barrels 235  
Give notice before plugging to all available Lease Owners, as required by Rule (10).  
When plugging completed, file final Plugging Report, duly signed and sworn to. All necessary forms will be furnished by the Deputy Supervisor of district in which well is located.  
NOTE: If no log available, so state and give all information that can be obtained to as total depth, whether or not cemented, producing formation, water sands, and as near as possible date well was drilled.  
General Remarks: Producing sand depleted. Well no longer economical to produce.

RECEIVED

FILL OUT FORMATION AND AFFIDAVIT ON REVERSE SIDE

NOV - 2 1959

Railroad Commission of Texas  
OIL & GAS DIVISION  
HOUSTON, TEXAS

FORMATION RECORD

Show All Formations, Especially All Sands and Character and Contents Thereof

STATION NO.

RECEIVED  
NOV - 3 1950  
Railroad Commission of Texas  
OIL & GAS DIVISION  
AUSTIN, TEXAS

*L. C. Burns*  
Notary Public  
Bragoria County, Texas

Refer to File No. ....

RAILROAD COMMISSION OF TEXAS  
OIL AND GAS DIVISION

Form 1

APPLICATION TO DRILL, DEEPEN OR PLUG BACK  
IS THIS AN APPLICATION TO DRILL, DEEPEN OR PLUG BACK, Plug Back  
FILE IN DUPLICATE WITH DEPUTY SUPERVISOR OF DISTRICT IN WHICH WELL IS LOCATED

RET

READ CAREFULLY AND  
COMPLY FULLY

In order that it may be ascertained whether or not the proposed location covered by this notice conforms to the applicable spacing regulations set down by the Railroad Commission, there are two important footages that must be shown; that is, THE NEAREST DISTANCE OF PROPOSED LOCATION FROM LEASE OR PROPERTY LINE AND DISTANCE OF PROPOSED LOCATION FROM THE NEAREST WELL ON THE SAME LEASE. Do not begin drilling operations on any location prior to filing Form 1 and until permit granted by the Commission has been received and waiting clause period has terminated.

For the purpose of this department draw on the back side hereof a neat, accurate sketch made to scale, of this lease, block, or lot, locating thereon the proposed site for this location with reference to the two nearest lease lines. Also show the nearest wells on all sides of this location and the distance from the proposed location to these wells. In addition to the foregoing, unit boundary designations must be shown for each producing well on the lease and shall include proposed unit boundaries for the location herein applied for showing the acreage to be assigned to this well. Give names and addresses of adjoining lease or property owners, and designate all property by lease and company name. You may attach a blue print showing this information if you so desire.

DO NOT CONFUSE SURVEY LINES WITH LEASE LINES. IF THE SKETCH OR BLUE PRINT SHOWS ONLY A SECTION, BLOCK, OR LOT OUT OF YOUR LEASE, DESIGNATE SAME AS BEING ONLY THAT PART OF THE LEASE.

When the size of the tract will permit, use scale of one inch equaling 1000 feet; if less than one acre use scale of one inch equaling 100 feet. DESIGNATE SCALE TO WHICH PLAT OR SECTION IS DRAWN. ALSO DESIGNATE NORTHERLY DIRECTION ON THE SKETCH OR PLAT.

FILL IN BELOW IN THE SPACES RESERVED FOR THIS PURPOSE THE FOOTAGES ASKED FOR:

Nearest distance from proposed location to property or lease line.....467'.....feet.

Distance from proposed location to nearest drilling, completed, or applied for well on same lease.....19'.....feet.

Date.....July 15,..... 1959.....

Name of company or operator

Name.....Phillips Petroleum Company.....

Address.....P.O. Drawer 272.....

City.....Alvin, Texas.....

Description of farm or lease (Guaranty)

Name of Lease.....Stewart Title & Guaranty Co......

Number of Acres.....30.....Well No.....1.....

Number of wells on lease.....1.....

Survey.....A. F. Austin League 3-A.....

Elevation.....231.....Feet  
(Above Sea Level)

Section No.....S/D-N.....Block No.....7.....

Located in.....League City.....Field

(If Wildcat state above)

.....Galveston.....County

.....2.65.....Miles.....SW.....direction from

.....League City.....nearest postoffice or town.

Rotary or Cable Tools.....Permanent Type Comp......

Date work will start drilling.....When Permit Received.....

Depth to which you propose to drill.....7.....feet.

Date work will start deepening.....7.....

IF LEASE PURCHASED WITH ONE OR MORE WELLS DRILLED, FROM WHOM PURCHASED?

Name.....Stewart Title & Guaranty Co......

Address.....Stewart Title & Guaranty Co......

Note: Refer to initial application to drill, filed December 8, 1938.

NOTICE: Before sending in this form be sure that you have given all information requested. Much unnecessary correspondence will thus be avoided.

RECEIVED

DRAW SKETCH AND MAKE AFFIDAVIT ON REVERSE SIDE

JUL 17 1959

Railroad Commission of Texas  
OIL & GAS DIVISION  
HOUSTON, TEXAS

S.F. AUSTIN  
A-3

RASKORA

GARDENS

Phillips

C.E. Duggan

Phillips

30 Ac.

Stewart Title & Guaranty Co.

10,362'

"Guaranty"

467'

Annie Winhurst 25 Ac.

Stewart Title & Guaranty Co.

J.G. Oll

Geo. Echols

Phillips

Midstates

J.M. PERRY & E.M. AUSTIN  
A-19

PHILLIPS PETROLEUM COMPANY BARTLESVILLE, OKLAHOMA

GUARANTY LEASE - 30 ACRES  
S.F. AUSTIN SUR., A-3  
GALVESTON CO. TEXAS



Please refer to File No.

RAILROAD COMMISSION OF TEXAS  
OIL & GAS DIVISION

Form 1

APPLICATION TO DRILL OR DEEPEN

IS THIS AN APPLICATION TO DRILL OR DEEPEN Field No. 1

FILE IN DUPLICATE WITH DEPUTY SUPERVISOR OF DISTRICT IN WHICH WELL IS LOCATED Recomplete in 6900' Sand.

READ CAREFULLY AND  
COMPLY FULLY

In order that it may be ascertained whether or a proposed location covered by this Article conforms the applicable spacing regulations set down by the Railroad Commission, there are the important footages that need shown; that is, THE NEAREST DISTANCE OF PROPOSED LOCATION FROM LEASE OR PROPERTY LINE AND DISTANCE OF PROPOSED LOCATION FROM THE NEAREST WELL ON THE SAME LEASE. Do not begin drilling operations on any location prior to filing Form 1 and until permit granted by the Commission has been received and waiting clause period has terminated.

For the purpose of this determination draw on the back side hereof a neat, accurate sketch, made to scale, of this lease, block, or lot locating thereon the proposed site for this location with reference to the two nearest lease lines. Also show the nearest wells on all sides of of this location and the distance from the proposed location to those wells. In addition to the foregoing, unit boundary designations must be shown for each producing well on the lease and shall include proposed unit boundaries for the location herein applied for showing the acreage to be assigned this well. Give names and addresses of adjoining lease or property owners, and designate all property by lease and company name. You may attach a blue print showing this information if you so desire.

DO NOT CONFUSE SURVEY LINES WITH LEASE LINES. IF THE SKETCH OR BLUE PRINT SHOWS ONLY A SECTION, BLOCK, OR LOT OUT OF YOUR LEASE, DESIGNATE SAME AS BEING ONLY THAT PART OF THE LEASE.

Where the size of the tract will permit, use scale of one inch equaling 1000 feet; if less than 2 acres use scale of one inch equaling 100 feet. DESIGNATE SCALE TO WHICH PLAN OR SKETCH IS DRAWN. ALSO DESIGNATE NORTHERLY DIRECTION ON THE SKETCH OR PLAN.

FILL IN BELOW IN THE SPACES RESERVED FOR THIS PURPOSE THE FOOTAGES ASKED FOR:

Nearest distance from proposed location to property or lease line... 467' ... NEARLY feet.

Distance from proposed location to nearest drilling, completed, or applied for well on same lease... 7 feet.

APPROVED AND AUTHORIZED  
LARRY RUTHERFORD

Date... June 1 ... 1934

Name of company or operator

Name... Phillips Petroleum Company

Address... P. O. Drawer 272

City... Alvin, Texas

Description of farm or lease: (Guaranty)

Name of Lease... Stewart Title & Guaranty Co.

Number of Acres... 272.2 ... Well No. 1

Number of wells on lease... 1

Survey... S. F. Austin League 3-A

Elevation... 7 feet  
(ABOVE SEA LEVEL)

Section... 8/D-1 ... Block No. 7

Located... League City ... Field

(If Wildcat state above)

... Galveston ... County

... 2.65 ... Miles... SW ... direction from

... League City ... nearest postoffice or town.

Rotary or Cable... Rotary

Date work will start... when permit received.

Depth to which you propose to drill... 7 feet.

Date work will start opening... 7

IF LEASE PURCHASED WITH ONE OR MORE WELLS DRILLED, FROM WHOM PURCHASED?

Name... Phillips Petroleum Company

Address... Alvin, Texas

NOTE: Refer to initial application to drill, filed December 8, 1933.

NOTICE: Before sending in this form be sure that you have given all information requested. Much unnecessary correspondence will thus be avoided.

DRAW SKETCH AND MAKE AFFIDAVIT ON REVERSE SIDE  
2 - Railroad Commission of Texas

FILE No.

DRAW SKETCH IN SPACE BELOW OF COUNTRY AND LEASE PLAT  
(Be sure that all required locations, locs, 2, 3, 4, 5, 6, 7, 8, 9, 10, 11, 12, 13, 14, 15, 16, 17, 18, 19, 20, 21, 22, 23, 24, 25, 26, 27, 28, 29, 30, 31, 32, 33, 34, 35, 36, 37, 38, 39, 40, 41, 42, 43, 44, 45, 46, 47, 48, 49, 50, 51, 52, 53, 54, 55, 56, 57, 58, 59, 60, 61, 62, 63, 64, 65, 66, 67, 68, 69, 70, 71, 72, 73, 74, 75, 76, 77, 78, 79, 80, 81, 82, 83, 84, 85, 86, 87, 88, 89, 90, 91, 92, 93, 94, 95, 96, 97, 98, 99, 100, 101, 102, 103, 104, 105, 106, 107, 108, 109, 110, 111, 112, 113, 114, 115, 116, 117, 118, 119, 120, 121, 122, 123, 124, 125, 126, 127, 128, 129, 130, 131, 132, 133, 134, 135, 136, 137, 138, 139, 140, 141, 142, 143, 144, 145, 146, 147, 148, 149, 150, 151, 152, 153, 154, 155, 156, 157, 158, 159, 160, 161, 162, 163, 164, 165, 166, 167, 168, 169, 170, 171, 172, 173, 174, 175, 176, 177, 178, 179, 180, 181, 182, 183, 184, 185, 186, 187, 188, 189, 190, 191, 192, 193, 194, 195, 196, 197, 198, 199, 200, 201, 202, 203, 204, 205, 206, 207, 208, 209, 210, 211, 212, 213, 214, 215, 216, 217, 218, 219, 220, 221, 222, 223, 224, 225, 226, 227, 228, 229, 230, 231, 232, 233, 234, 235, 236, 237, 238, 239, 240, 241, 242, 243, 244, 245, 246, 247, 248, 249, 250, 251, 252, 253, 254, 255, 256, 257, 258, 259, 260, 261, 262, 263, 264, 265, 266, 267, 268, 269, 270, 271, 272, 273, 274, 275, 276, 277, 278, 279, 280, 281, 282, 283, 284, 285, 286, 287, 288, 289, 290, 291, 292, 293, 294, 295, 296, 297, 298, 299, 300, 301, 302, 303, 304, 305, 306, 307, 308, 309, 310, 311, 312, 313, 314, 315, 316, 317, 318, 319, 320, 321, 322, 323, 324, 325, 326, 327, 328, 329, 330, 331, 332, 333, 334, 335, 336, 337, 338, 339, 340, 341, 342, 343, 344, 345, 346, 347, 348, 349, 350, 351, 352, 353, 354, 355, 356, 357, 358, 359, 360, 361, 362, 363, 364, 365, 366, 367, 368, 369, 370, 371, 372, 373, 374, 375, 376, 377, 378, 379, 380, 381, 382, 383, 384, 385, 386, 387, 388, 389, 390, 391, 392, 393, 394, 395, 396, 397, 398, 399, 400, 401, 402, 403, 404, 405, 406, 407, 408, 409, 410, 411, 412, 413, 414, 415, 416, 417, 418, 419, 420, 421, 422, 423, 424, 425, 426, 427, 428, 429, 430, 431, 432, 433, 434, 435, 436, 437, 438, 439, 440, 441, 442, 443, 444, 445, 446, 447, 448, 449, 450, 451, 452, 453, 454, 455, 456, 457, 458, 459, 460, 461, 462, 463, 464, 465, 466, 467, 468, 469, 470, 471, 472, 473, 474, 475, 476, 477, 478, 479, 480, 481, 482, 483, 484, 485, 486, 487, 488, 489, 490, 491, 492, 493, 494, 495, 496, 497, 498, 499, 500, 501, 502, 503, 504, 505, 506, 507, 508, 509, 510, 511, 512, 513, 514, 515, 516, 517, 518, 519, 520, 521, 522, 523, 524, 525, 526, 527, 528, 529, 530, 531, 532, 533, 534, 535, 536, 537, 538, 539, 540, 541, 542, 543, 544, 545, 546, 547, 548, 549, 550, 551, 552, 553, 554, 555, 556, 557, 558, 559, 560, 561, 562, 563, 564, 565, 566, 567, 568, 569, 570, 571, 572, 573, 574, 575, 576, 577, 578, 579, 580, 581, 582, 583, 584, 585, 586, 587, 588, 589, 590, 591, 592, 593, 594, 595, 596, 597, 598, 599, 600, 601, 602, 603, 604, 605, 606, 607, 608, 609, 610, 611, 612, 613, 614, 615, 616, 617, 618, 619, 620, 621, 622, 623, 624, 625, 626, 627, 628, 629, 630, 631, 632, 633, 634, 635, 636, 637, 638, 639, 640, 641, 642, 643, 644, 645, 646, 647, 648, 649, 650, 651, 652, 653, 654, 655, 656, 657, 658, 659, 660, 661, 662, 663, 664, 665, 666, 667, 668, 669, 670, 671, 672, 673, 674, 675, 676, 677, 678, 679, 680, 681, 682, 683, 684, 685, 686, 687, 688, 689, 690, 691, 692, 693, 694, 695, 696, 697, 698, 699, 700, 701, 702, 703, 704, 705, 706, 707, 708, 709, 710, 711, 712, 713, 714, 715, 716, 717, 718, 719, 720, 721, 722, 723, 724, 725, 726, 727, 728, 729, 730, 731, 732, 733, 734, 735, 736, 737, 738, 739, 740, 741, 742, 743, 744, 745, 746, 747, 748, 749, 750, 751, 752, 753, 754, 755, 756, 757, 758, 759, 760, 761, 762, 763, 764, 765, 766, 767, 768, 769, 770, 771, 772, 773, 774, 775, 776, 777, 778, 779, 780, 781, 782, 783, 784, 785, 786, 787, 788, 789, 790, 791, 792, 793, 794, 795, 796, 797, 798, 799, 800, 801, 802, 803, 804, 805, 806, 807, 808, 809, 810, 811, 812, 813, 814, 815, 816, 817, 818, 819, 820, 821, 822, 823, 824, 825, 826, 827, 828, 829, 830, 831, 832, 833, 834, 835, 836, 837, 838, 839, 840, 841, 842, 843, 844, 845, 846, 847, 848, 849, 850, 851, 852, 853, 854, 855, 856, 857, 858, 859, 860, 861, 862, 863, 864, 865, 866, 867, 868, 869, 870, 871, 872, 873, 874, 875, 876, 877, 878, 879, 880, 881, 882, 883, 884, 885, 886, 887, 888, 889, 890, 891, 892, 893, 894, 895, 896, 897, 898, 899, 900, 901, 902, 903, 904, 905, 906, 907, 908, 909, 910, 911, 912, 913, 914, 915, 916, 917, 918, 919, 920, 921, 922, 923, 924, 925, 926, 927, 928, 929, 930, 931, 932, 933, 934, 935, 936, 937, 938, 939, 940, 941, 942, 943, 944, 945, 946, 947, 948, 949, 950, 951, 952, 953, 954, 955, 956, 957, 958, 959, 960, 961, 962, 963, 964, 965, 966, 967, 968, 969, 970, 971, 972, 973, 974, 975, 976, 977, 978, 979, 980, 981, 982, 983, 984, 985, 986, 987, 988, 989, 990, 991, 992, 993, 994, 995, 996, 997, 998, 999, 1000)

NORTH

June 1954

NOTE: See location plat attached to initial Form 1, dated December 8, 1938, covering application to drill.

RECEIVED

JUN - 4 1954

Railroad Commission of Texas  
OIL & GAS DIVISION  
HOUSTON, TEXAS

SOUTH

NOTAL: ANY WELL DE ASSIGNED TO any well which does not have sufficient surface casing to protect all fresh water sands, where Commission rules do not specify surface casing requirements, it will be necessary to contact Board of Water Engineers, Austin, Texas, to ascertain the depth to which fresh water sands must be protected.

Scale of Plat.....

I, Ralph J. C. King, being first duly sworn on oath, state that I have knowledge of the facts and matter herein set forth and that the same are true and correct.

Name.....

Title District Superintendent

Subscribed and sworn to before me this 1st day of June, 1954.

Correspondence regarding this well should be addressed to:

Notary Public

Brasoria

County, Texas.

Ralph J. C. King

Address P. O. Drawer 272, Alvin, Texas

This form must be filed in District Office not later than ten days after date of completion of test or penalty assessed. Do not take test for period of time less than specified by field rules.

RAILROAD COMMISSION OF TEXAS  
OIL AND GAS DIVISION  
FURNISH ALL DATA IN FULL. DO NOT USE ESTIMATES.  
(SEE INSTRUCTIONS ON REVERSE SIDE)

FORM 2  
**RECEIVED**  
MAR 10 1953  
Railroad Commission of Texas  
OIL & GAS DIVISION  
HOUSTON, TEXAS

FIELD NAME: League City  
RAILROAD COMMISSION DISTRICT NUMBER: Three  
NAME OF OPERATOR: Phillips Petroleum Co. LEASE: Guaranty WELL NO. 1  
ADDRESS: Alvin, Texas SECTION: A23 BLOCK: 240 - 11  
P. O. BOX NO. 272 SURVEY S.P. 272.2 ELEVATION 22.5  
COUNTY IN WHICH WELL IS LOCATED: Galveston Unit: Galveston No. in Unit: 272.2  
Date potential test commenced: March 3 to March 4 Hour: 7:00 A.M.  
Date potential test completed: March 4 Hour: 7:00 A.M.  
Has this lease changed operating name within the last 60 days? No If so, what was the previous operating name?  
Has the log of this well been filed with Deputy Supervisor? Yes Date log filed: 3-30-39

Data Necessary on Flowing Well

Flowing pressure on csg: Packer  
Flowing pressure on tbg: 2171  
Length of test: 24 Hrs. 0 Mins.  
Size choke: 10/64 Make choke: Positive  
Was this well flowed for the entire duration of this test without the use of wash or other artificial flowing device? Yes  
Is this well being jetted? No  
If being jetted, how many cubic feet of gas is being used to one barrel of oil recovered?  
Oil producing during this test into: Tank (TANK OR PIT)

Data Necessary on Pumping Well

Make of Pumping unit:  
Length of stroke used:  
No. strokes per minute:  
Size working barrel:  
Length of test:  
Was any oil produced from this well during this test lifted from the test hole to the surface of the ground by the use of any device or means the use of which is not prescribed by the Railroad Commission in establishing potentials?  
Date:

Date this well was last shot or acidized: — If shot: — If acidized: —  
Barrels of oil produced from this well since shot or treatment to time this test was started: —  
Barrels of oil produced from this well from its completion date or reworked completion date to the beginning of this test: 125  
Percent water produced during this test: 20% Total depth of this well: PTD 9855 Ft.  
Is this a test of a new well for which no previous allowable has been assigned? No  
Is this a plain retest (not a workover job) of a well which has a current allowable assigned? No  
What is the 24-hour potential at which it is carried currently on production? No  
If this test is the result of a workover what was the nature of the job? Squeeze 9848-521, Perforate 9846-68  
Hour well completed: 6:00 P.M. Date well completed: March 3, 1953

TEST PRODUCTION DATA

(Furnish Tank Numbers, Size, Avg. Bbls. per Ft., and all gauges in Ft. and In. and Bbls.)

(Indicate manner in which production arrived at by placing result in proper column.)

TANK NO.	SIZE	BBL PER FOOT	GAUGE AT BOTTOM				PRODUCTION COMPUTED			PRODUCTION 99% Tank Tables	PRODUCTION 100% Tank Tables
			LOW		HIGH		Feet	In.	Bbl.		
			Feet	In.	Feet	In.					
1	300	16.12	1	8	11	14	9	5	1/4		152.13
	</										

RESULT OF THIS POTENTIAL TEST (Bbls. of Crude oil per 24 hours): 152.13 (100% Tank, Tbl.)  
OAS/OIL RATIO OF THIS WELL IS 1.685 (Cubic ft. of gas per barrel of Crude Oil)  
Gravity of oil produced during this test (Corrected to A.P.I. 60 degrees): 32.0  
(OVER)

Watt 12150 3/4 + 60 (90-150)

# DATA ON WELL COMPLETION

Notice of intention to drill this well was filed in the name of Phillips Petroleum Co.  
 Date of notice of intention to drill was filed 12-8-38  
 Is Location "REGULAR," or was "SPECIAL PERMIT" required? Regular  
 If special permit was secured what is permit number? -  
 Total number of acres in this lease 272.2  
 Number of crude oil producing wells on this lease in this field, including the well on which this  
 potential was taken ONE  
 Location of well relative to lease boundaries of lease on which this well is located: 467 feet from South  
 line and 467 feet from East line of the Steward Title Guaranty lease  
 Size of surface casing 10-3/4" O.D. Number feet of surface casing set 304316"  
 Size of oil string 7" OD Number of feet of oil string run 10,384.13"  
 Type of tubing head OCT Type of Bradenhead OCT  
 Top of pay 9824 Ft. Total depth PTD 9855 Ft. Size tubing run 2-3/8"  
 Perforated from 9846' to 9848' No. Shots 8 No. ft. tubing run 9833.78'  
 Kind of fuel used to drill this well Gas Amt of fuel used Est. 68,250 MCF  
 Where fuel was secured Cron & Gracey's Davant #1 & Fee #1, Dickinson Field

INSTRUCTIONS: All potential test forms, WITH ALL INFORMATION REQUESTED THEREON FILLED IN, shall be filed in the District Office of the Railroad Commission not later than ten (10) days after the test is completed and, should the operator fail to file potential test in an acceptable form within the ten (10) days as specified then the effective date of the allowable resulting from such test shall not extend back more than ten (10) days prior to receipt and acceptance of the potential test form in the office of the Deputy Supervisor. This ten-day provision shall govern regardless of whether the potential test is taken during the month in which it is received in the office of the Deputy Supervisor or any prior month.

EACH WITNESS MUST SIGN IN HIS OWN HANDWRITING.

We, the undersigned, witnessed this test and the top and bottom gauges of each tank into which production was run during duration of this test.

Steward S. T. Walker  
 Representative of Company making test  
 None for None  
 Representative of Offset Operator  
John W. Jones for Phillips Pipe Line Co.  
 Pipe Line Owner Pipe Line Company

Representative of the Railroad Commission \_\_\_\_\_

## APPIDAVIT:

I HEREBY CERTIFY that all conditions prescribed by the Railroad Commission of Texas for this potential test were complied with and carried out in full, and that all data and facts set forth on both sides of this form are true and correct.

Steward Dist. Supt. for Phillips Petroleum Co.  
 Representative of Company making test Company making test

SUBSCRIBED AND SIGNED before me this the 5th day of March, 1939

(Notary Seal)

L. G. Burns  
 L. G. Burns

Notary Public in and for Brazoria County, Texas.

REMARKS:

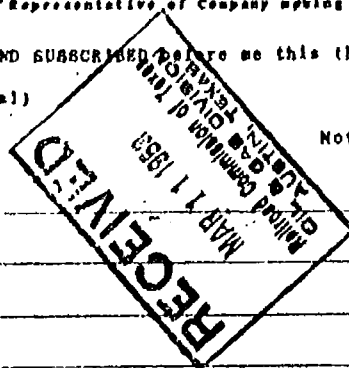



MAR 13 1952

# DATA ON WELL COMPLETION

"Notice of Intention to Drill" this well was filed in name of Phillips Petroleum Company  
 Date "Notice of Intention to Drill" was filed 12-18-38  
 Is location "REGULAR," or was "SPECIAL PERMIT" required? Regular  
 If special permit was secured what is permit number? ---  
 Total number of acres in this lease 272.2  
 Number of crude oil producing wells on this lease in this field, including the well on which this potential was taken One  
 Location of well, relative to lease boundaries of lease on which this well is located: 467 feet from South line and 467 feet from East line of the Stenart Title Guaranty lease.  
 Size of surface casing 10-3/4" OD Number feet of surface casing set 3043' 6"  
 Size of oil string 7" OD Number of feet of oil string run 10,384' 3"  
 Type of tubing head OQT Type of Bradenhead CGT  
 Top of pay 9824 Ft. Total Depth PTD 9854 Ft. Size tubing run 2-3/8" CD  
 Perforated from 9848' to 9852' No. Shots 16 No. ft. tubing run 9804.06'  
 Kind of fuel used to drill this well Gas Amt. of fuel used EST. 68,250 MCF  
 Where fuel was secured Cron & Gracey's Davant #1 & Fee #1, Dickinson Field

## INSTRUCTIONS:

All potential test forms, WITH ALL INFORMATION REQUESTED THEREON FILLED IN, shall be filed in the District Office of the Railroad Commission not later than five (5) days after the test is completed and, should the operator fail to file potential test in an acceptable form within the five (5) days as specified then the effective date of the allowable resulting from such test shall not extend back more than five (5) days prior to receipt and acceptance of the potential test form in the office of the Deputy Supervisor. This five-day provision shall govern regardless of whether the potential test is taken during the month in which it is received in the office of the Deputy Supervisor or any prior month.

Any potential test form resulting from a retest of an oil well which is received in the district office of the Deputy Supervisor after the fifteenth (15th) of the month shall not be used as the basis for establishing a new allowable before the issuance of the proration schedule for the next succeeding month.

This test must be witnessed by either (1) a representative of the company making the test together with a representative of the Railroad Commission or (2) a representative of the company making the test, a representative of one offset operator, and the pipe line gauger for the pipe line running the oil from this well.

EACH WITNESS MUST SIGN IN HIS OWN HANDWRITING.

We, the undersigned, witnessed this test and the top and bottom gauges of each pipe into which production was run during duration of this test.

Shwallow Dist. Supt.  
 Representative of Company making test

None for  
 Representative of Offset Operator

None for  
 Representative of Pipe Line Company

Representative of the Railroad Commission

## AFFIDAVIT:

I HEREBY CERTIFY that all conditions prescribed by the Railroad Commission of Texas for this potential test were complied with and carried out in full, and that all data and facts set forth on both sides of this form are true and correct.

Shwallow Dist. Supt. for Phillips Petroleum Company  
 Representative of Company making test

SWORN TO AND SUBSCRIBED before me this 11 day of March, 1952

(Notary Seal)

L.C. Burns  
 Notary Public in and for Brazoria County, Texas.

## REMARKS:

RECEIVED  
 MAR 15 1952

OIL & GAS DIVISION  
 TEXAS RAILROAD COMMISSION  
 HOUSTON, TEXAS

