

Phase 1

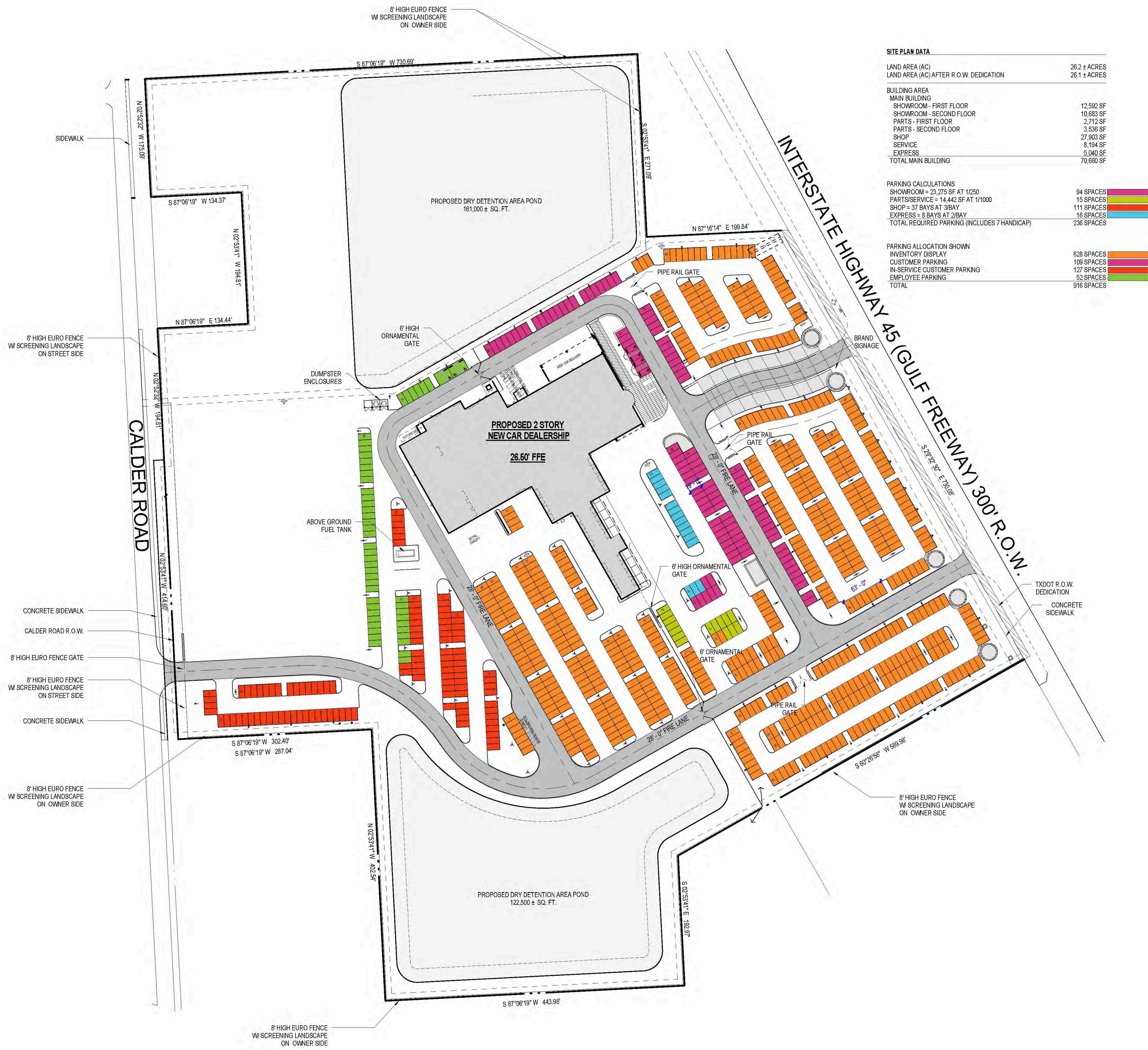

HONDA

HONDA OF CLEAR LAKE

The RATLIFF Group

200 EAST BELTLINE ROAD
SUITE 304
COPPELL, TX 75019
TELEPHONE: (972) 304-8800

BREWER ESCALANTE
CIVIL ENGINEERING AND LANDSCAPE ARCHITECTURE
13430 NW FREEWAY
SUITE 350
HOUSTON, TX 77040
TELEPHONE: (832) 615-0301

JJA INC.
MECHANICAL ENGINEER
8150 NORTH CENTRAL EXPRESSWAY
M-2100 CAMPBELL CENTRE
DALLAS, TEXAS 75206
TELEPHONE: (214) 739-8880

L.A. FUESS PARTNERS, INC.
STRUCTURAL ENGINEER
3333 LEE PARKWAY
SUITE 300
DALLAS, TX 75219
TELEPHONE: (214) 871-7010

Date	Description
08-12-16	DESIGN DEVELOPMENT
10-17-2016	ISSUED FOR CONSTRUCTION

Seal / Signature

PRELIMINARY

THESE DOCUMENTS ARE INCOMPLETE AND NOT FOR REGULATORY APPROVAL, PERMITTING OR CONSTRUCTION.

Erick del Angel, AIA
TEXAS ARCHITECT REGISTRATION # 19496

Project Name

HONDA OF CLEAR LAKE

Project Number

27.6846.000

Description

ARCHITECTURAL SITE PLAN -PHASE 01

Scale

1" = 80'-0"

A00.10

Phase 2



SITE PLAN DATA	
LAND AREA (AC)	26.2 ± ACRES
LAND AREA (AC) AFTER R.O.W. DEDICATION	26.1 ± ACRES
BUILDING AREA	
MAIN BUILDING	13,989 SF
SHOWROOM - FIRST FLOOR	10,983 SF
SHOWROOM - SECOND FLOOR	2,712 SF
PARTS - FIRST FLOOR	3,536 SF
PARTS - SECOND FLOOR	27,903 SF
SERVICE	8,194 SF
EXPRESS	6,991 SF
TOTAL MAIN BUILDING	73,988 SF
CAR WASH	1,715 SF
TOTAL BUILDING AREA	75,703 SF
PARKING CALCULATIONS	
SHOWROOM = 24,662 SF AT 1/250	99 SPACES
PARTS/SERVICE = 14,442 SF AT 1/1000	15 SPACES
SHOP = 37 BAYS AT 36/BAY	111 SPACES
EXPRESS = 12 BAYS AT 2/BAY	24 SPACES
TOTAL REQUIRED PARKING (INCLUDES 7 HANDICAP)	249 SPACES
PARKING ALLOCATION SHOWN	
CUSTOMER PARKING	112 SPACES
IN-SERVICE CUSTOMER PARKING	130 SPACES
EMPLOYEE PARKING	58 SPACES
INVENTORY DISPLAY	1,614 SPACES
TOTAL	1,953 SPACES



The RATLIFF Group
200 EAST BELTLINE ROAD
SUITE 304
CORPUS CHRISTI, TX 78401
TELEPHONE: (361) 304-8800

BREWER ESCALANTE
CIVIL ENGINEERING AND LANDSCAPE ARCHITECTURE
13430 NW FREEWAY
SUITE 350
HOUSTON, TX 77040
TELEPHONE: (832) 615-0301

JJA INC.
MECHANICAL ENGINEER
8150 NORTH CENTRAL EXPRESSWAY
M-2100 CAMPBELL CENTRE
DALLAS, TEXAS 75206
TELEPHONE: (214) 739-8880

L.A. FUESS PARTNERS, INC.
STRUCTURAL ENGINEER
3333 LEE PARKWAY
SUITE 300
DALLAS, TX 75219
TELEPHONE: (214) 871-7010

Date	Description
08-12-16	DESIGN DEVELOPMENT
10-17-2016	ISSUED FOR CONSTRUCTION

Seal / Signature

PRELIMINARY

THESE DOCUMENTS ARE INCOMPLETE AND NOT FOR REGULATORY APPROVAL, PERMITTING OR CONSTRUCTION.

Erick del Angel, AIA
TEXAS ARCHITECT REGISTRATION # 19496

Project Name
HONDA OF CLEAR LAKE

Project Number
27.6846.000

Description
ARCHITECTURAL SITE PLAN

Scale
1" = 80'-0"

Ref North

A00.11