



A-1 CONSTRUCTION SERVICES
6108 Brittmoore Road ♦ Houston, Texas ♦ 77041
Phone 713-975-1819 ♦ Fax 713-975-9158 ♦ www.a1sp.com



Letter of Transmittal

To: City of League City Building Official

From: Justin Wing, A-1 Construction Services

Date: 10/26/2017

Re: Brookport Drive – League City, TX 77573

Description: Pinnacle Park – Brookport Drive - Site Lighting Permit Transmittal

Documents Transmitted:

1. City of League City Commercial Permit Application – 2 Pages
2. MV Electric, Inc. – Brookport Drive Site Lighting Plan – 1 Page
3. Brookport Drive Site Lighting Plan – As Built Drawing – 1 Page
4. Burrus & Matthew, Inc. – Brookport Drive Lighting Layout Photometric Plan – 4 Pages
5. RAB Lighting – ALED2T150 – Product Information Sheet – 2 Pages
6. Hapco Pole Products – SSS30D6-4-BM – Product Information Sheet -1 Page
7. Braun Intertec – Light Pole Concrete Bases Letter – 120 MPH Wind Requirement – 5 Pages

RECEIVED BY: _____ **DATE:** _____



City of League City

200

Commercial Permit Application

500 W. Walker St. League City, TX 77573 Phone: 281-554-1429 Fax: 281-554-1460

Project Address:	Pinnacle Park - Brookport Drive	Permit No.:	
	1502 1/2 Brookport Drive	Date:	
	League City, Texas 77573	Fee Due: \$	
Estimated Cost of Construction: \$60,000.00		CRF's Due: \$	
Describe work to be done:		Total Permit Fee Cost: \$	
Roadway lighting to serve Brookport Drive		Subtract Plan Review: \$	
(When permit is approved) Final Amount Due: \$			
Legal Description:	Lot:	Block:	Subdivision:
Section:			
Type of permit:	(Check all that apply.)		
BUILDING <input checked="" type="checkbox"/>	MECHANICAL <input type="checkbox"/>	ELECTRICAL <input checked="" type="checkbox"/>	
PLUMBING <input type="checkbox"/>	GAS <input type="checkbox"/>	OTHER <input type="checkbox"/>	
Owner:	General Contractor:		
101 League City I-45/646, L.P.	A-1 Construction Services		
Street: 6108 Brittmoore Road, Suite 200	Street: 6108 Brittmoore Road, Suite 100		
City, State, Zip: Houston, Texas 77041	City, State, Zip: Houston, Texas 77041		
Phone No.: 713-944-2224	Phone No.: 713-975-1819		
E-Mail: jmeador@a1sp.com	E-Mail: jwing@a1sp.com		
Subcontractors:	Company Name	Master's Name	
Electrical: MV Electric, Inc.		Clay Fife	
Plumbing:			
Mechanical:			
Other:			
Building Information:	Total Area:	Flood Zone:	Base Flood Elevation:
	Stories:		Finished Floor:
Type of Construction (IBC Ch 5):			Lowest Adjacent Grade:
Occupant Load:		Elevation Cert. <input type="checkbox"/>	No Rise Cert. <input type="checkbox"/>
Provided Documents:	Submit one (1) copy of each (that applies) on a digital CD.		
Survey <input type="checkbox"/>	Plot Plan <input type="checkbox"/>	Energy Cert. <input type="checkbox"/>	
Plumbing / Gas Riser <input type="checkbox"/>	Mechanical Layout <input type="checkbox"/>	Elec. Load Analysis <input type="checkbox"/>	
Construction Plans <input checked="" type="checkbox"/>	Asbestos Survey <input type="checkbox"/>	TDLR # <input type="checkbox"/>	
If not using city service, attach a copy of the approved County Health District permit for this address.			
Private Sewage Permit <input type="checkbox"/>	Well Permit <input type="checkbox"/>	Other <input type="checkbox"/>	
NOTE: Construction or modification of all structures over 250 sq. ft. requires an engineered windstorm design to meet 120 mph, along with foundation and framing plans sealed by an engineer at the time of permit submittal. Upon project completion, proof of TD1 Windstorm Certification must be provided to the Building Official for final occupancy to be granted.			
Additional Department / Agency Approvals:		Operations Permit <input type="checkbox"/>	
Development Review DRC <input type="checkbox"/>	Fire Marshal <input type="checkbox"/>	Historic District <input type="checkbox"/>	
		County Health District <input type="checkbox"/>	
Additional Comments:			
Storm Water Pollution Prevention Plan (SWPPP) should be in place at <u>all</u> times during construction.			
NOTICE: I HEREBY CERTIFY THAT I HAVE READ AND EXAMINED THIS APPLICATION AND KNOW THE SAME TO BE TRUE AND CORRECT. ALL PROVISIONS OF LAWS AND ORDINANCES GOVERNING THE TYPE OF WORK WILL BE COMPLIED WITH, WHETHER SPECIFIED OR NOT. THE GRANTING OF A PERMIT DOES NOT PRESUME TO GIVE AUTHORITY TO VIOLATE OR CANCEL THE PROVISIONS OF ANY OTHER STATE OR LOCAL LAW REGULATING CONSTRUCTION OR THE PERFORMANCE OF CONSTRUCTION. I UNDERSTAND THE LEAGUE CITY CONSTRUCTION TIMES ARE FROM 7:00AM TO 7:00PM AND CITATIONS WILL BE ISSUED IF NOT COMPLIANT.			
APPLICANT'S SIGNATURE			
Printed Name: Justin Wing			
Phone No.: 713-975-1819			
E-Mail: jwing@a1sp.com			
Initial Review			
By: Date:			
Approved			
By: Date:			



City of League City

200

Commercial Permit Application

500 W. Walker St. League City, TX 77573 Phone: 281-554-1429 Fax: 281-554-1460

Project Address:	Pinnacle Park - Pinnacle Park Drive	Permit No.:	
	Pinnacle Park Drive @ Brookport Drive	Date:	
	League City, Texas 77573	Fee Due:	\$
Estimated Cost of Construction: \$80,000.00		CRF's Due:	\$

Building Permit	Construction cost over:	
	Per Additional \$1000:	
	Plus :	
	Scheduled Base Fee:	
	Plan Review Fee:	
	Total:	\$

Electrical Permit	Cost Per:	Quantity:	Subtotal
Scheduled Base Fee:	\$25.00	1	
Meter Loop:	\$10.00	0	
For each Circuit:			
1 Pole	\$5.00		
2 Pole	\$10.00		
3 Pole	\$15.00	0	
Temporary Service Pole (T-Pole):	\$25.00		
Temporary Cut In (TCI):	\$25.00		
Transformer (per KVA):	\$5.00	0	
	Total:		\$ 25.00

Plumbing Permit	Cost Per:	Quantity:	Subtotal
Scheduled Base Fee:	\$25.00		
Each fixture, floor drain, or trap:	\$3.00		
Sewer (new, replaced, or repaired)	\$10.00		
	Total:		\$

Gas Permit	Cost Per:	Quantity:	Subtotal
Scheduled Base Fee:	\$25.00		
Each fixture outlet:	\$5.00		
	Total:		\$

Mechanical Permit	Cost Per:	Quantity:	Subtotal
Scheduled Base Fee:	\$25.00		
Each Cooling Unit ≤ 5 ton:	\$30.00		
Cooling Units over 5 tons (per Ton):	\$10.00		
Boilers (per 500K Btu of input):	\$10.00		
	Total:		\$

Total of all permit fees: \$

BIG IDEA

MV ELECTRIC, INC.
TECL #26820

Electrical Design-Builders
MV ELECTRIC, INC.
Clay Fife (ME #177313)
11811 BELLE CT
PINEHURST TX 77362
Phone: (832) 713-4132

MV Electric, Inc.

Clay Fife
Master Electrician #177313

Pinnacle Park
A Mixed-Use Town Center Development • League City, Texas

[illegible]

Brookport Drive Site Lighting Plan

Project number	14A80012
Date	8.29.2016
Drawn by	JAW
Checked by	JAW
LP 1.01	
Scale	As indicated

10/30/2016 10:01:37 AM

① BROOKPORT DRIVE SITE LIGHTING PLAN
1" = 50'-0"

GENERAL NOTES

- ### **GENERAL NOTES**
- A. THE CONTRACTOR IS RESPONSIBLE FOR VERIFYING ALL CONDITIONS PRIOR TO COMMENCEMENT OF CONSTRUCTION. A GEOTECHNICAL REPORT IS AVAILABLE FROM THE OWNER. THE CONTRACTOR SHALL ADHERE TO THE RECOMMENDATIONS OF THE GEOTECHNICAL ENGINEER.
 - B. THE CONTRACTOR IS RESPONSIBLE FOR EXAMINING ALL SITE CONDITIONS PRIOR TO COMMENCEMENT OF CONSTRUCTION AND SHALL COMPALE FIELD CONDITIONS WITH DRAWING NOTS.
 - C. THE CONTRACTOR SHALL BE RESPONSIBLE FOR VERIFYING ALL UTILITY INFORMATION SHOWN ON THE PLANS PRIOR TO THE START OF CONSTRUCTION. THE CONTRACTOR SHALL CALL TEXAS 811 TO NOTIFY UTILITY COMPANIES OF HIS INTENTIONS, AND TO REQUEST FIELD STAKING OF EXISTING UTILITIES.
 - D. SITE CONTRACTOR TO COORDINATE WITH ALL THIRD PARTY CONTRACTORS AND UTILITY COMPANIES AS NEEDED DURING THE PROJECT.
 - E. MINIMUM CONDUIT SIZE FOR ALL UNDERGROUND CONDUITS SHALL BE 1".
 - F. ROUTE CONDUITS UNDER SURFACE TO AVOID CONFLICTS WITH LANDSCAPING AND LAWN IRRIGATION.
 - G. PROVIDE A GREEN INSULATED GROUND WIRE IN ALL BRANCH CIRCUITS.
 - H. PROVIDE A DEDICATED NEUTRAL CONDUIT FOR EACH BRANCH CIRCUIT. SHARED NEUTRALS ARE NOT ALLOWED UNLESS NOTED OTHERWISE.
 - I. PROVIDE A FULL Sizing ALL POLE ENTRY CONDUITS.
 - J. CONTRACTOR SHALL VERIFY MINIMUM TYPICAL NUTS AND INSTALLATION REQUIREMENTS PRIOR TO ORDERING.
 - K. MINIMUM DEPTH OF UG-4T HOLES TO BE 10' 4" BELOW FINISH GRADE.

KEY NOTES

- NOTES**
1. ELECTRICAL POINT OF SERVICE, COORDINATE WITH TNPV FOR DETAILS.
 2. RAIL LIGHTING, AL002150 FIXTURE, TYPICAL. HAPCO STEEL POLE PRODUCTS SSS3035-4-BM POLF, TYPICAL.
 3. LOCATE EXISTING UTILITY SLEEVES. ROUTE LIGHTING CONDUIT THROUGH EXISTING UTILITY SLEEVE.
 4. CONCRETE LIGHT POLE BASES TO BE INSTALLED AT A MINIMUM OF 2'-0" FROM BACK OF CURB AT DRIVE.

LIGHTING FIXTURE SCHEDULE							
FIXTURE TYPE	DESCRIPTION	MANUFACTURER	CATALOG NUMBER	LAMP TYPE	MOUNTING	VOLTAGE	DESCRIPTION
A1	POLE LIGHT	RAB	ALED2T150	150W LED	4 @90 DEGREES	100-277V	POLE MOUNT, LED, AREA LIGHT

LIGHT POLE SCHEDULE						
POLE TYPE	DESCRIPTION	MANUFACTURER	CATALOG NUMBER	TYPE	FINISH	STEEL GAUGE
A	LIGHT POLE	HAFCO	SSS30DG 4-BM	6" SQUARE STEEL POLE	BRONZE POWDER PAINT	7

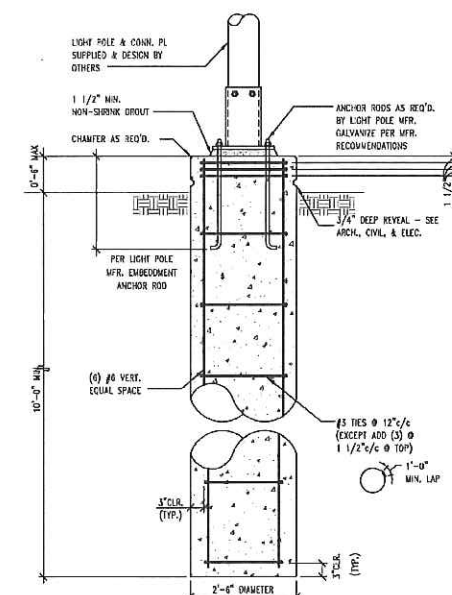

**INSTALL ELECTRICAL CONDUIT FOR SITE LIGHTING AT A MINIMUM DEPTH OF 2'-0" BELOW FINISH GRADE, TYPICAL.

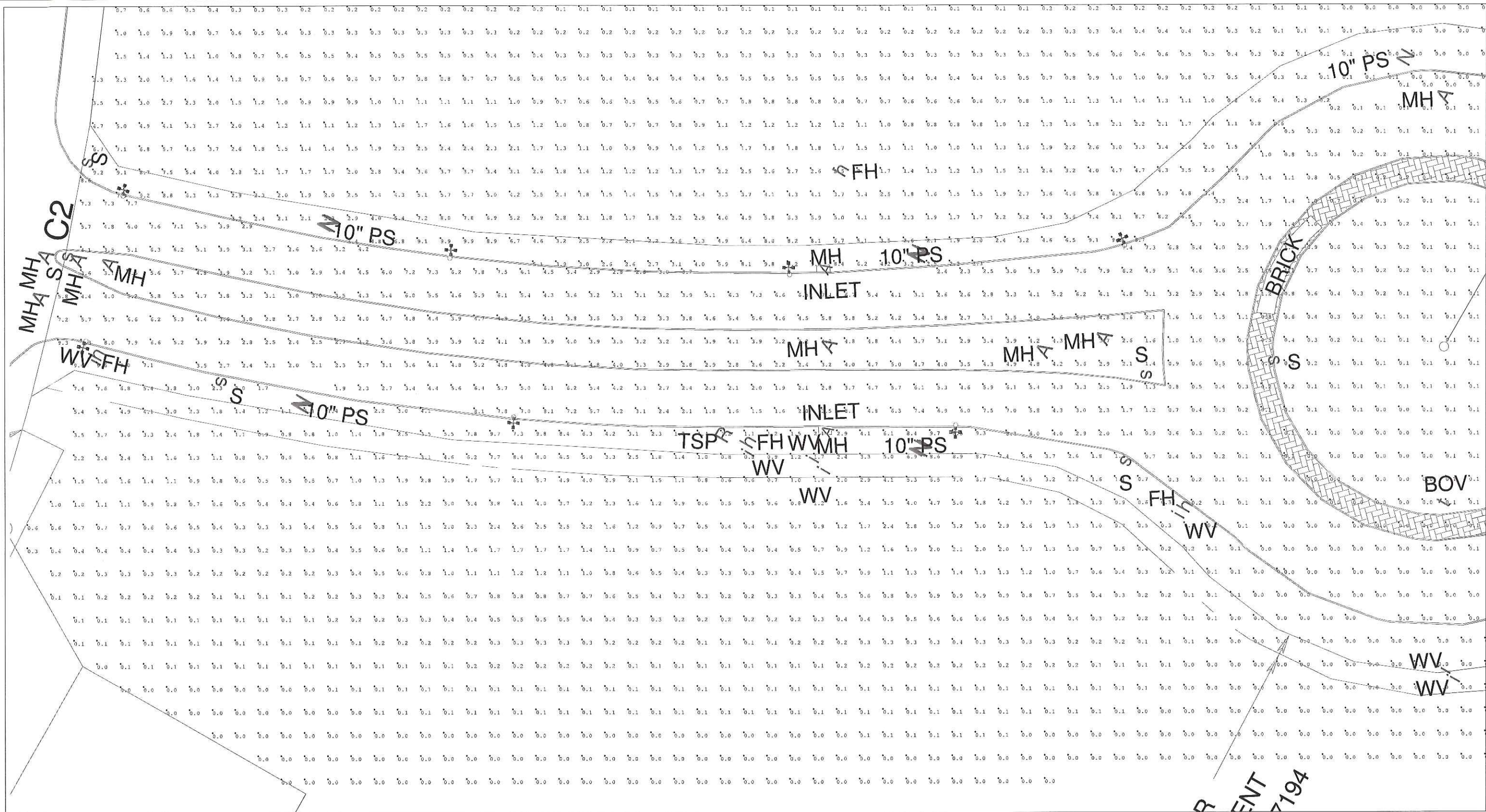

Scale: 1 inch= 40 Ft.



Prepared For:

Job Name:

Lighting Layout
Version A

Scale: as noted

Date:8/19/2016

Filename: Final.AGI

Drawn By:Chris Sims

Filename: C:\Users\Christopher\Documents\Lighting Layouts\Aug 16\City Matt Dunn\Final.AGI

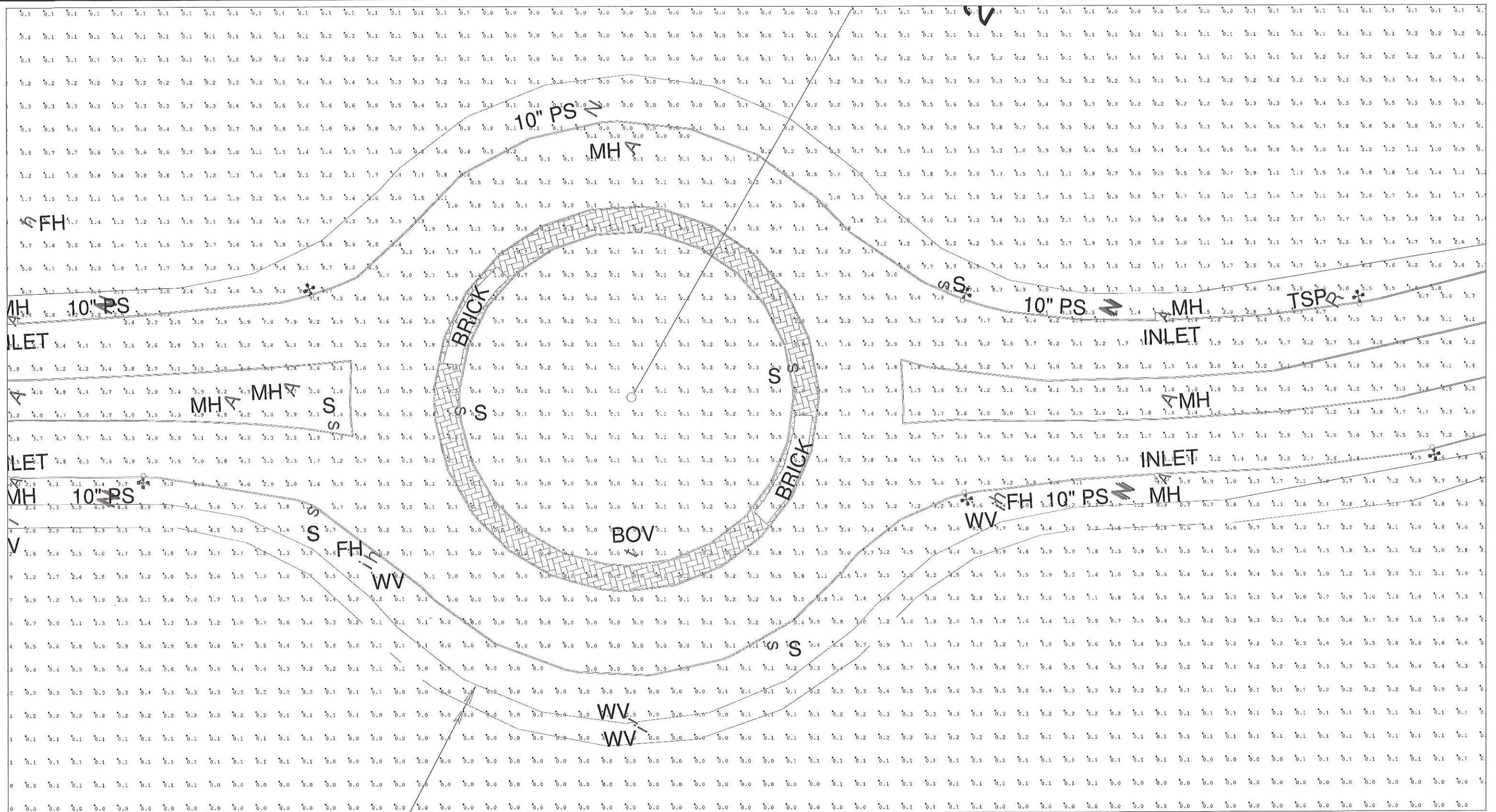

Scale: 1 inch= 40 Ft.



Prepared For:

Job Name:

Lighting Layout
Version A

Scale: as noted

Date: 8/19/2016

Filename: Final.AGI

Drawn By: Chris Sims

Filename: C:\Users\Christopher\Documents\Lighting Layouts\Aug 16\City Matt Dunn\Final.AGI

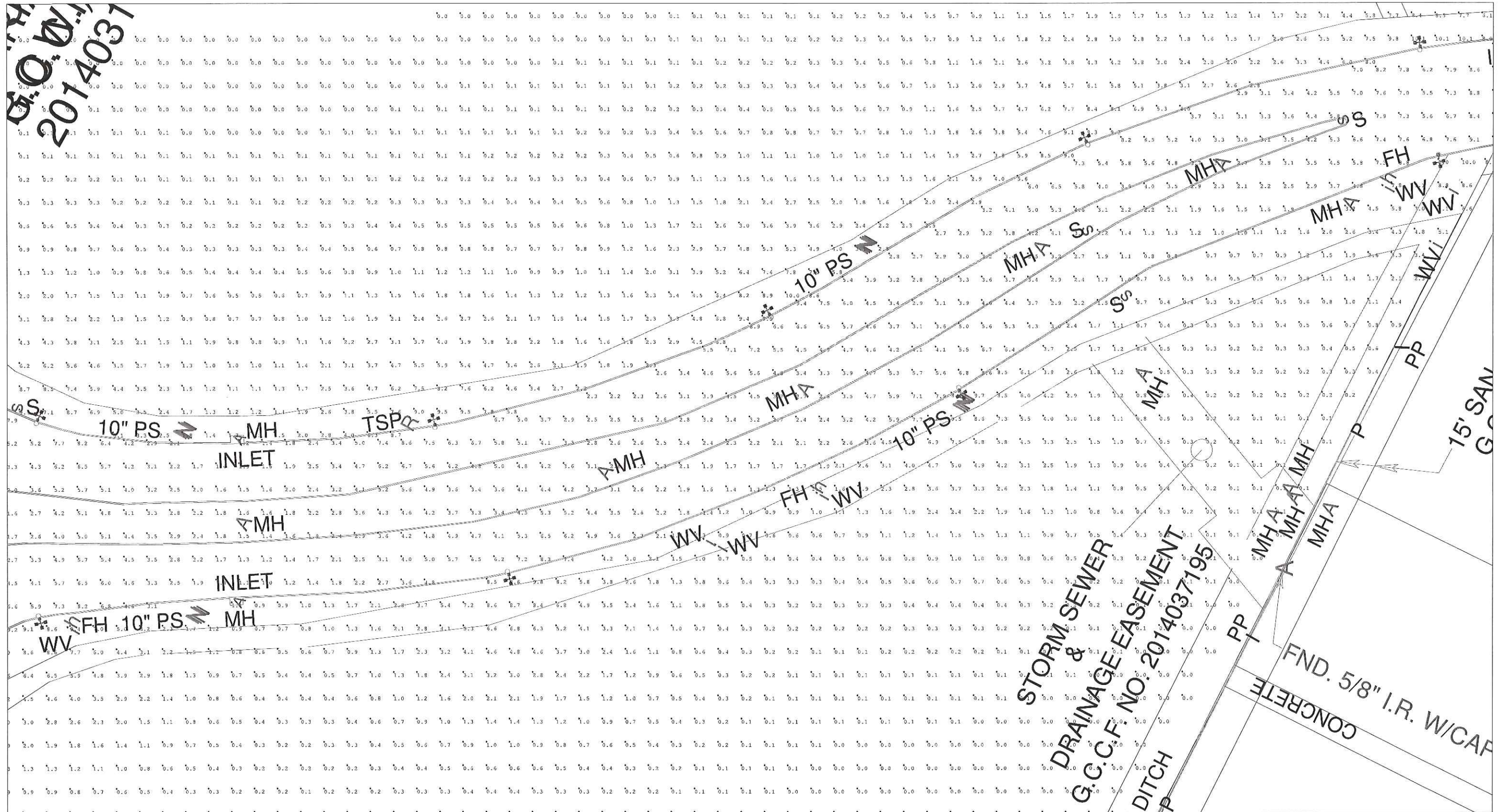

Scale: 1 inch= 40 Ft.



Prepared For:

Job Name:

Lighting Layout
Version A

Scale: as noted



Date:8/19/2016

Filename: Final.AGI

Drawn By:Chris Sims

Filename: C:\Users\Christopher\Documents\Lighting Layouts\Aug 16\City Matt Dunn\Final.AGI

Calculation Summary

Label			CalcType	Units	Avg	Max	Min	Avg/Min	Max/Min	Description	PtSpcLr	PtSpcTb	Meter Type				
CalcPts_1			Illuminance	Fc	0.99	10.0	0.0	N.A.	N.A.		10	10	Horizontal				
CalcPts_2			Illuminance	Fc	1.49	10.1	0.0	N.A.	N.A.		10	10	Horizontal				
CalcPts_3			Illuminance	Fc	2.86	9.4	0.0	N.A.	N.A.		10	10	Horizontal				
CalcPts_4 Schedule																	
Symbol	Qty	Tag	Label		Arrangement		Lum. Lumens		Arr. Lum. Lumens		LLF	Description		Lum. Watts	Arr. Watts	Total Watts	Filename
	16	A	ALED4T1503 @ 90		3 @ 90 DEGREE		514349		43047		1.000	TType IV Area Light - 3 @ 90		155.7	467.1	7473.6	ALED4T150 - Cool - ITL79629.IES
	16	B	ALED2T150 - Cool - I		SINGLE		14038		14038		1.000	Type II area light		153.7	153.7	2459.2	ALED2T150 - Cool - ITL79617.IES

Expanded Luminaire Location Summary

LumNo	Tag	X	Y	MTG HT
2	A	-1168.911	250.898	30
2	A	-1171.462	249.677	30
2	A	-1167.69	248.347	30
3	A	-1027.871	224.661	30
3	A	-1029.997	222.795	30
3	A	-1026.005	222.535	30
4	A	-882.042	217.014	30
4	A	-884.051	215.023	30
4	A	-880.051	215.005	30
5	A	-1187.453	179.079	30
5	A	-1185.061	180.589	30
5	A	-1188.963	181.471	30
6	A	-1001.006	146.169	30
6	A	-998.899	148.056	30
6	A	-1002.893	148.276	30
7	A	-809.91	141.916	30
7	A	-807.911	143.917	30
7	A	-811.911	143.915	30
8	A	-738.831	228.985	30
8	A	-739.807	226.331	30
8	A	-736.177	228.009	30
9	A	-453.192	226.726	30
9	A	-455.85	225.76	30
9	A	-452.226	224.068	30
10	A	-453.099	134.055	30
10	A	-451.603	136.455	30
10	A	-455.499	135.551	30
11	A	-284.541	225.11	30
11	A	-285.885	222.622	30
11	A	-282.053	223.766	30
12	A	-250.564	152.77	30
12	A	-249.205	155.251	30

Total Quantity: 64 (32 shown, 1 through 32)

Expanded Luminaire Location Summary

LumNo	Label	X	Y	Z	Orient
12	ALED4T1503 @ 90	-253.045	154.129	30	196.295
13	ALED4T1503 @ 90	-141.343	271.986	30	117.539
13	ALED4T1503 @ 90	-142.191	269.288	30	207.539
13	ALED4T1503 @ 90	-138.645	271.138	30	27.539
14	ALED4T1503 @ 90	-55.669	232.288	30	300.572
14	ALED4T1503 @ 90	-54.964	235.027	30	30.572
14	ALED4T1503 @ 90	-58.408	232.993	30	210.572
15	ALED4T1503 @ 90	-4.364	346.135	30	112.753
15	ALED4T1503 @ 90	-5.434	343.517	30	202.753
15	ALED4T1503 @ 90	-1.746	345.065	30	22.753
16	ALED4T1503 @ 90	149.729	331.55	30	285.606
16	ALED4T1503 @ 90	151.117	334.014	30	15.606
16	ALED4T1503 @ 90	147.265	332.938	30	195.606
17	ALED4T1503 @ 90	140.761	386.941	30	96.157
17	ALED4T1503 @ 90	138.988	384.738	30	186.157
17	ALED4T1503 @ 90	142.964	385.168	30	6.157
18	ALED2T150 - Cool - ITL79617	141.231	382.969	30	277.337
19	ALED2T150 - Cool - ITL79617	148.803	336.66	30	102.194
20	ALED2T150 - Cool - ITL79617	-2.853	342.432	30	291.631
21	ALED2T150 - Cool - ITL79617	-57.862	235.628	30	126.021
22	ALED2T150 - Cool - ITL79617	-139.415	268.358	30	304.981
23	ALED2T150 - Cool - ITL79617	-251.509	156.653	30	101.056
24	ALED2T150 - Cool - ITL79617	-283.483	220.883	30	284.147
25	ALED2T150 - Cool - ITL79617	-454.254	137.875	30	110.576
26	ALED2T150 - Cool - ITL79617	-455.011	223.167	30	240.897
27	ALED2T150 - Cool - ITL79617	-737.222	225.324	30	292.654
28	ALED2T150 - Cool - ITL79617	-809.98	145.584	30	90.057
29	ALED2T150 - Cool - ITL79617	-882.025	213.014	30	270.733
30	ALED2T150 - Cool - ITL79617	-1000.74	150.16	30	85.67
31	ALED2T150 - Cool - ITL79617	-1028.00	220.665	30	270.011
32	ALED2T150 - Cool - ITL79617	-1186.57	182.982	30	77.358
33	ALED2T150 - Cool - ITL79617	-1169.77	247.247	30	249.404



Prepared For:

Job Name:

Lighting Layout
Version A

Scale: N.T.S.

Date:8/19/2016

Filename: Final.AGI

Drawn By:Chris Sims

Filename: C:\Users\Christopher\Documents\Lighting Layouts\Aug 16\City Matt Dunn\Final.AGI

ALED2T150

Specification grade area lights available in IES Type II distributions.
For use in parking lots, roadways, pathways and general area lighting.
Replaces up to 400W metal halide. Patent pending thermal management system. 5 Year Warranty.

LED Info

Watts: 150W
Color Temp: 5000K (Cool)
Color Accuracy: 65
L70 Lifespan: 100000
LM79 Lumens: 14038
Efficacy: 91 LPW

Driver Info

Type: Constant Current
120V: 1.31A
208V: 0.80A
240V: 0.69A
277V: 0.60A
Input Watts: 154W
Efficiency: 98%

Technical Specifications

UL Listing:

Suitable for wet locations.

Lifespan:

100,000-hour LED lifespan based on IES LM-80 results and TM-21 calculations.

IES Classification:

The Type II distribution is ideal for wide walkways, on ramps and entrance roadways, bike paths and other long and narrow lighting applications. This type is meant for lighting larger areas and usually is located near the roadside. This type of lighting is commonly found on smaller side streets or jogging paths.

Effective Projected Area:

EPA = 0.75

LEDs:

Multi-chip, high-output, long-life LEDs

Drivers:

Two Drivers, Constant Current, Class 2, 2000mA, 100-277V, 50-60Hz, 1.1A, Power Factor 99%

THD:

6.6% at 120V, 12.1% at 277V

Ambient Temperature:

Suitable for use in 40°C (104°F) ambient temperatures.

Surge Protection:

4kV

Cold Weather Starting:

The minimum starting temperature is -40°F/-40°C.

Thermal Management:

Superior thermal management with external Air-Flow fins.

Color: Bronze

Weight: 32.0 lbs

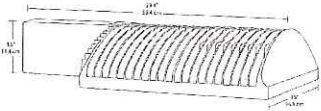

Housing:

Die-cast aluminum housing, lens frame and mounting arm.

Mounting:

Heavy-duty mounting arm with "O" ring seal & stainless steel screws

Color Consistency:

7-step MacAdam Ellipse binning to achieve consistent fixture-to-fixture color.

Color Stability:

LED color temperature is warrantied to shift no more than 200K in CCT over a 5 year period.

Color Uniformity:

RAB's range of CCT (Correlated Color Temperature) follows the guidelines of the American National Standard for Specifications for the Chromaticity of Solid State Lighting (SSL) Products, ANSI C78.377-2011.

Reflector:

Specular vacuum-metallized polycarbonate

Gaskets:

High-temperature silicone gaskets

Finish:

Our environmentally friendly polyester powder coatings are formulated for high-durability and long-lasting color, and contains no VOC or toxic heavy metals.

Green Technology:

Mercury and UV free, and RoHS compliant. Polyester powder coat finish formulated without the use of VOC or toxic heavy metals.



Tech Help Line: 888 RAB-1000

Email: sales@rabweb.com

On the web at: www.rabweb.com

Copyright ©2014 RAB Lighting Inc. All Rights Reserved

Note: Specifications are subject to change without notice

ALED2T150 - continued

IESNA LM-79 & LM-80 Testing:

RAB LED luminaires have been tested by an independent laboratory in accordance with IESNA LM-79 and LM-80, and have been received the Department of Energy "Lighting Facts" label.

DLC Listed:

This product is on the Design Lights Consortium (DLC) Qualified Products List and is eligible for rebates from DLC Member Utilities.

Replacement:

The ALED150 replaces 400W Metal Halide Area Lights.

California Title 24:

See ALED2T150/D10, ALED2T150/BL, ALED2T150/PCS, ALED2T150/PCS2, or ALED2T150/PCT for a 2013 California Title 24 compliant product. Any additional component requirements will be listed in the Title 24 section under technical specifications on the product page.

Dark Sky Approved:

The International Dark Sky Association has approved this product as a full cutoff, fully shielded luminaire.

For use on LEED Buildings:

IDA Dark Sky Approval means that this fixture can be used to achieve LEED Credits for Light Pollution Reduction.

Warranty:

RAB warrants that our LED products will be free from defects in materials and workmanship for a period of five (5) years from the date of delivery to the end user, including coverage of light output, color stability, driver performance and fixture finish.

Country of Origin:

Designed by RAB in New Jersey and assembled in the USA by RAB's IBEW Local 3 workers.

Buy American Act Compliant:

This product is a COTS item manufactured in the United States, and is compliant with the Buy American Act.

Recovery Act (ARRA) Compliant:

This product complies with the 52.225-21 "Required Use of American Iron, Steel, and Manufactured Goods-- Buy American Act-- Construction Materials (October 2010).

Trade Agreements Act Compliant:

This product is a COTS item manufactured in the United States, and is compliant with the Trade Agreements Act.



Tech Help Line: 888 RAB-1000

Email: sales@rabweb.com

On the web at: www.rabweb.com

Copyright ©2014 RAB Lighting Inc. All Rights Reserved

Note: Specifications are subject to change without notice

SSS

Square Straight Steel Pole
No Arm — 4-Bolt Base

A Mounting Height

Removable Pole Cap
(Tenon Option Available -
See Mounting Designation)

D Top Square

B Wall Gauge
Square Straight Steel Tube
ASTM A500 Grade B Steel

Handhole

C Butt Square

4-Bolt Base
With Cover

1'-6"

Finish

BA = Black Powder Coat (ABS Plastic Base Cover)
BH = White Powder Coat (ABS Plastic Base Cover)
BM = Dark Bronze Powder Coat (ABS Plastic Base Cover)
BV = Dark Green Powder Coat
GC = Gray Powder Coat
OOG = Galvanized Only
(No Powder Coat)
BAG = Black Powder Coat
Over Galvanized
BHG = White Powder Coat
Over Galvanized
BMG = Dark Bronze Powder Coat
Over Galvanized
BVG = Dark Green Powder Coat
Over Galvanized
GCG = Gray Powder Coat
Over Galvanized
** = Specify Finish

WARNING:

Do not install light pole
without luminaire.

Powder Coated, Galvanized or
Powder Coated over Galvanized Finish
Per Customer Specification.

A MTG. HGT.	B WALL GAUGE	C BUTT SQUARE	TOTAL LUM. WEIGHT	90	100	MAXIMUM EPA				CATALOG NUMBER
30	7	6	150	20.4	14.6	13.0	9.2	6.4	4.0	SSS30D6-4-**
C BUTT SQ.	D TOP SQ.	F BOLT CIRC. DIA.	G BASE SQ.	H BOLT PROJ.	I BOLT SIZE					
6	6	11 - 13	12.5	4.875	1 x 36 x 4					

Dimensions in Inches

CUSTOMER NAME:

PROJECT:LOCATION:

SSS30D6-4

FINISH

CATALOG NUMBER

Pole

Pole shaft shall be weldable-grade, cold-rolled, 7 gauge commercial quality carbon steel tubing conforming to ASTM A500 Grade B. All welds shall conform to AWS D1.2 using ER70S-6 electrodes.

Base Style

4-Bolt Steel Plate Base Flange of fabricated hot rolled carbon steel conforming to ASTM A36 or equivalent (36 ksi minimum yield) with 2-piece Base Cover and attaching hardware. Base Cover will be fabricated from ABS plastic or metal materials.

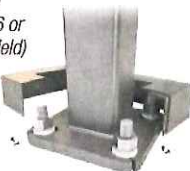

Handhole

Reinforced, 3" x 5" Handhole with Cover, Stainless Steel Screw and Backbar. A Grounding Provision incorporating a tapped 1/2"-13NC hole will be welded to the handhole frame.

Anchorage

Anchorage Kit will include four (4) L-shaped Steel Anchor Bolts conforming to AASHTO M314-90 Grade 55. Ten inches (10") of threaded end will be galvanized per ASTM A153. Kits will contain eight (8) Hex Nuts, four (4) Lock Washers, and eight (8) Flat Washers (all components Galvanized Steel). A bolt circle template will be provided.

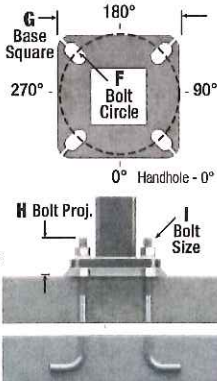

Vibration Damper

If determined necessary by Hapco, a top-mount, field installed First Mode Vibration Damper will be provided. Customer specification of the damper is available.

Mounting Designation

Side Drill Mount - For Side Drill Mount applications specify luminaire type, quantity and orientation. A luminaire drilling template must be supplied at time of order.

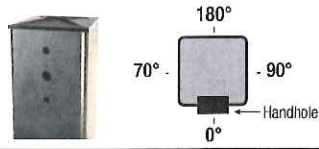

Tenon Mount - For Tenon Mount applications specify both Tenon diameter (2.375", 2.875", 3.5", 4", etc.) and length (3", 4", 5", 6", etc.).



EPA Notes:

Effective Projected Area (EPA) in square feet. EPA's calculated using wind velocity (mph) indicated in accordance with 2009 AASHTO LTS-5 using a 25 year design life. Maximum EPA is based on the luminaire weight shown. Increased luminaire weight may reduce the maximum EPA. If weight is exceeded, or if other design life or code is required, please consult the factory.



Braun Intertec Corporation
2522 Texas Ave.
Texas City, TX 77590

Phone: 409.948.8494
Web: braunintertec.com

September 1, 2017

Project 2615-0102

Mr. Justin Wing
A-1 Construction
6108 Brittmoore
Houston, Texas 77041
Main: (713) 975-1819
E-Mail: jwing@a1sp.com

Re: Light Pole Foundation Lateral Analysis (Rev-2)
Pinnacle Park
League City, Texas

Dear Mr. Wing:

This letter serves to provide A-1 Construction with the results of our analysis of the proposed light pole foundation elements to resist lateral loading for the project.

Background

A Geotechnical Engineering study was previously performed and reported on September 30, 2014 and a October 7, 2015, as well as a supplemental letter on March 4, 2015 with recommendations for the Light Pole Foundation Depths.

New Information

During the construction, the contractor proposed increasing the diameter of the drilled shaft elements supporting the light poles for the project from 24 inches to 30 inches. The project team requested that we perform additional analysis to evaluate if the installed depth of the drilled shaft foundation elements could be reduced and still resist the lateral wind loads acting on the 30-foot tall light poles.

Results

Lateral Analysis

We performed our lateral analysis of the light pole foundation drilled shaft elements using the provided lateral load of 734 pounds. We assumed the distributed wind load acting on the light pole could be resolved as an equivalent shear load acting at approximately 20 feet above the top of the shaft (2/3 the height of the pole) for a resulting moment of 14,680 feet-pounds. (176.2 inch-kips). We evaluated the 30-inch diameter shaft under a free head condition. We used the computer program LPILE (2016) to evaluate the lateral capacity of an individual pile based on the subsurface profile observed in Boring B-11.

In the lateral analysis, we neglected the upper three feet of soil to account for the presence of expansive soils at the site.

We have depicted the results of the lateral analysis graphically as an Attachment to this letter. If pile
AA/EOE

spacing closer than 5-pile diameters center-to-center is used in the final design, group effects should be considered in accordance with Table 10.7.2.4-1 from the AASHTO LRFD Bridge Design Manual.

The following table provides the soil parameters used for the lateral pile analysis and p-y curve generation.

Table 1. Lateral Analysis Soil Parameters

Layer Top Depth (feet)	Layer Bottom Depth (feet)	Effective Unit Weight (pcf)	Undrained Shear Strength (psf)	Material Type
0	8	110	1600	Stiff Clay w/o Free Water
8	20	115	3000	Stiff Clay w/o Free Water

Recommendations

Based on the results of our analysis, we recommend a minimum drilled shaft embedment of 8 feet below grade to resist the lateral wind loads acting on the light poles. This minimum depth will achieve the 120 mph wind loading requirement, as described in the Lateral Analysis section of this letter.

Remarks

With the exception of any results or recommendations changed by this Letter, the information contained in our Geotechnical Evaluation Report remains unchanged.

In performing its services, Braun Intertec used that degree of care and skill ordinarily exercised under similar circumstances by reputable members of its profession currently practicing in the same locality. No warranty, express or implied, is made.

If you have any questions about this Addendum, please contact Ryan Drury at 952.995.2229 or Michael Whitecotton at 409.948.8494.

Sincerely,

BRAUN INTERTEC CORPORATION

Michael J. Whitecotton, PE
Senior Geotechnical Engineer
License Number 101329





Ryan T. Drury
Associate Principal

F-12228
9-1-17

Attachments:
Lateral Analysis Results (3 pages)

Lateral Analysis Results

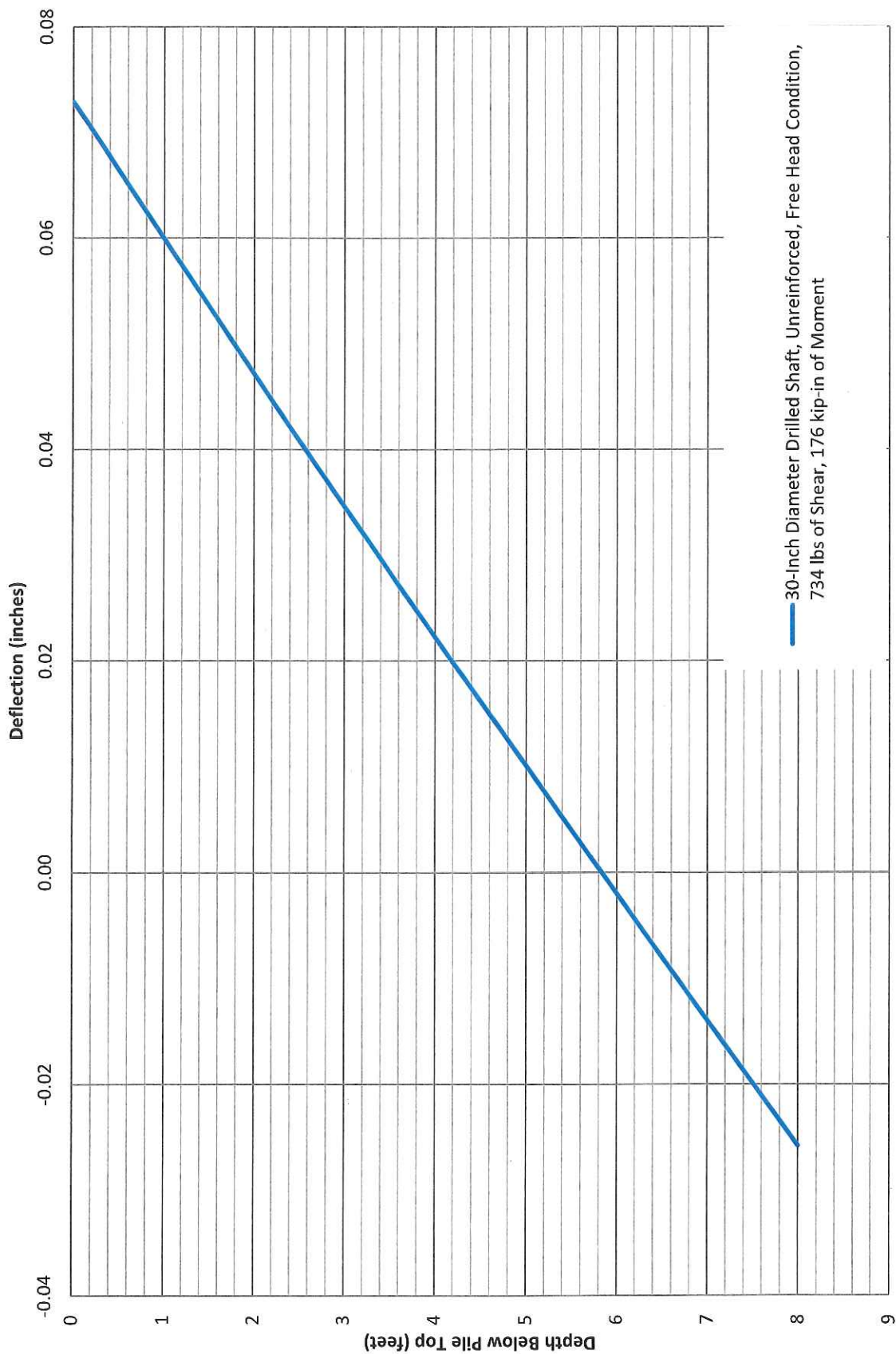
Boring: B-11
Pinnacle Park Light Pole
League City, Texas



Lateral Analysis Results

Boring: B-11
Pinnacle Park Light Pole
League City, Texas

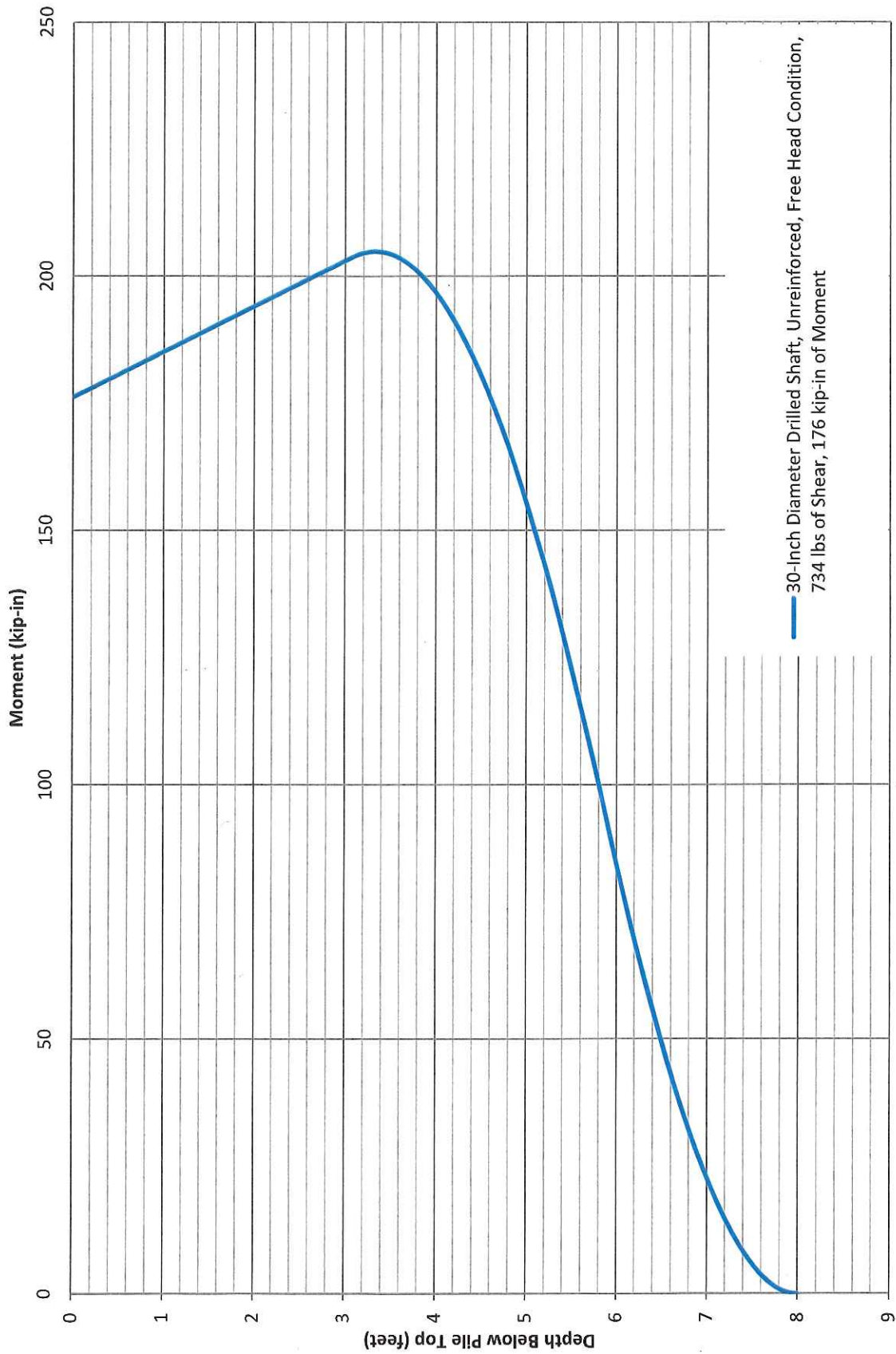

Lateral Analysis Results

Boring: B-11
Pinnacle Park Light Pole
League City, Texas

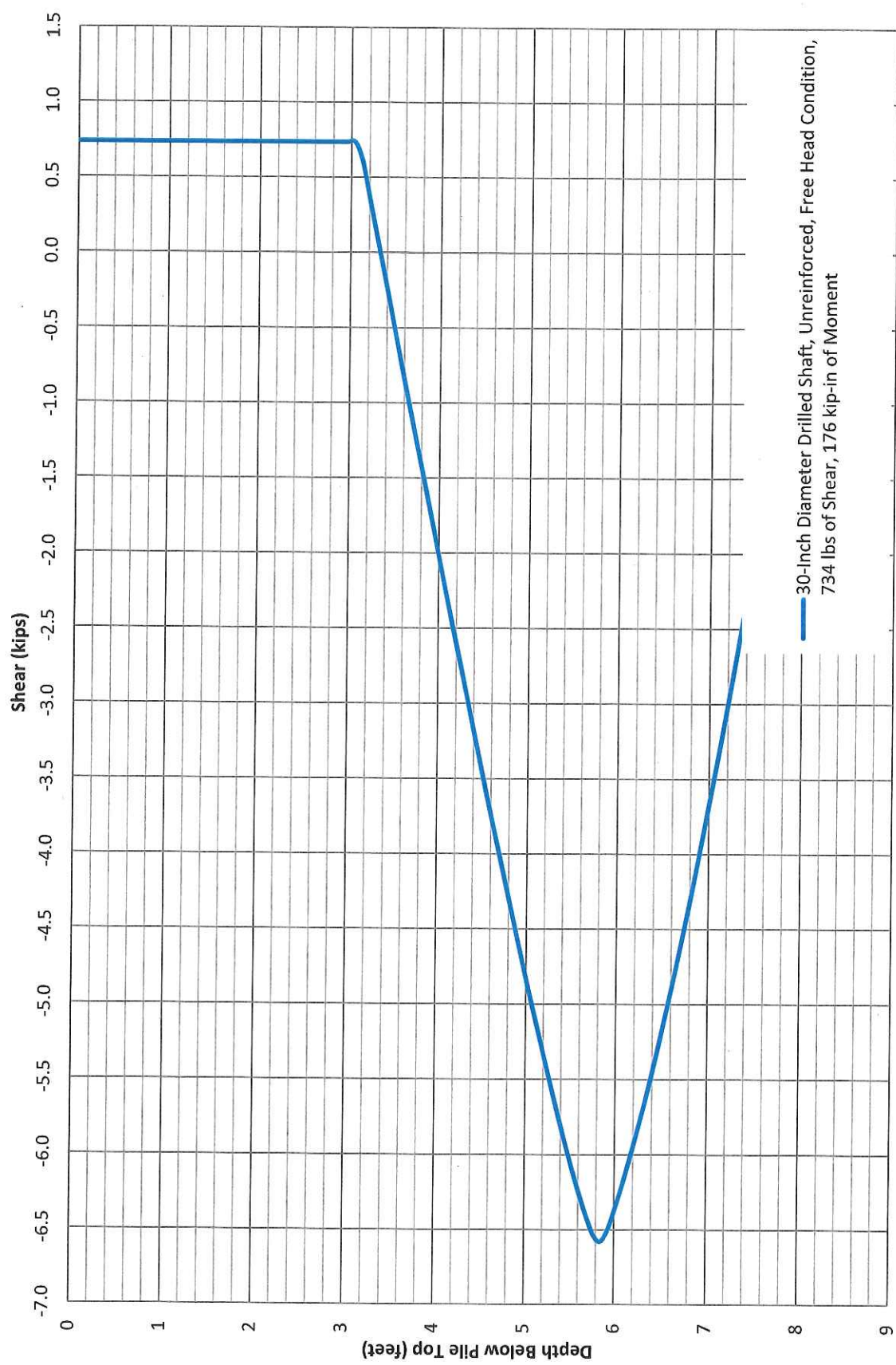



City of League City

200

Commercial Permit Application

500 W. Walker St. League City, TX 77573 Phone: 281-554-1429 Fax: 281-554-1460

Project Address:	Pinnacle Park - Pinnacle Park Drive	Permit No.:	
	Pinnacle Park Drive @ Brookport Drive	Date:	
	League City, Texas 77573	Fee Due: \$	
Estimated Cost of Construction:	\$ 120,000.00	CRF's Due: \$	

Describe work to be done:	Total Permit Fee Cost: \$
Concrete Sidewalk with Brick Pavers at Brookport Drive ROW	Subtract Plan Review: \$
(When permit is approved) Final Amount Due: \$	
Legal Description: Lot: Block: Subdivision: Section:	

Type of permit:	BUILDING <input checked="" type="checkbox"/>	MECHANICAL <input type="checkbox"/>	ELECTRICAL <input type="checkbox"/>	(Check all that apply.)
	PLUMBING <input type="checkbox"/>	GAS <input type="checkbox"/>	OTHER <input type="checkbox"/>	

Owner: 101 League City I-45/646, L.P.	General Contractor: A-1 Construction Services
Street: 6108 Brittmoore Road, Suite 200	Street: 6108 Brittmoore Road, Suite 100
City, State, Zip: Houston, Texas 77041	City, State, Zip: Houston, Texas 77041
Phone No.: 713-944-2224	Phone No.: 713-975-1819
E-Mail: jmeador@a1sp.com	E-Mail: jwing@a1sp.com

Subcontractors:	Company Name	Master's Name
Electrical:		
Plumbing:		
Mechanical:		
Other:		

Building Information:	Total Area:	Flood Zone:	Base Flood Elevation:
	Stories:		Finished Floor:
Type of Construction (IBC Ch 5):			Lowest Adjacent Grade:
Occupant Load:		Elevation Cert. <input type="checkbox"/>	No Rise Cert. <input type="checkbox"/>

Provided Documents:	Submit one (1) copy of each (that applies) on a digital CD.	
Survey <input type="checkbox"/>	Plot Plan <input type="checkbox"/>	Energy Cert. <input type="checkbox"/>
Plumbing / Gas Riser <input type="checkbox"/>	Mechanical Layout <input type="checkbox"/>	Elec. Load Analysis <input type="checkbox"/>
Construction Plans <input checked="" type="checkbox"/>	Asbestos Survey <input type="checkbox"/>	TDLR # <input type="checkbox"/>
If not using city service, attach a copy of the approved County Health District permit for this address.		
Private Sewage Permit <input type="checkbox"/>	Well Permit <input type="checkbox"/>	Other <input type="checkbox"/>
NOTE: Construction or modification of all structures over 250 sq. ft. requires an engineered windstorm design to meet 120 mph, along with foundation and framing plans sealed by an engineer at the time of permit submittal. Upon project completion, proof of TDI Windstorm Certification must be provided to the Building Official for final occupancy to be granted.		
Additional Department / Agency Approvals:		Operations Permit <input type="checkbox"/>
Development Review DRC <input type="checkbox"/>	Fire Marshal <input type="checkbox"/>	Historic District <input type="checkbox"/>
		County Health District <input type="checkbox"/>

Additional Comments:
Storm Water Pollution Prevention Plan (SWPPP) should be in place at <u>all</u> times during construction.

NOTICE: I HEREBY CERTIFY THAT I HAVE READ AND EXAMINED THIS APPLICATION AND KNOW THE SAME TO BE TRUE AND CORRECT. ALL PROVISIONS OF LAWS AND ORDINANCES GOVERNING THE TYPE OF WORK WILL BE COMPLIED WITH, WHETHER SPECIFIED OR NOT. THE GRANTING OF A PERMIT DOES NOT PRESUME TO GIVE AUTHORITY TO VIOLATE OR CANCEL THE PROVISIONS OF ANY OTHER STATE OR LOCAL LAW REGULATING CONSTRUCTION OR THE PERFORMANCE OF CONSTRUCTION.
I UNDERSTAND THE LEAGUE CITY CONSTRUCTION TIMES ARE FROM 7:00AM TO 7:00PM AND CITATIONS WILL BE ISSUED IF NOT COMPLIANT.
APPLICANT'S SIGNATURE
Printed Name: Justin Wing
Phone No.: 713-975-1819
E-Mail: jwing@a1sp.com

Initial Review
By: Date:

Approved
By: Date:



City of League City

200

Commercial Permit Application

500 W. Walker St. League City, TX 77573 Phone: 281-554-1429 Fax: 281-554-1460

Project Address:	Pinnacle Park - Pinnacle Park Drive	Permit No.:		
	Pinnacle Park Drive @ Brookport Drive		Date:	
	League City, Texas 77573		Fee Due: \$	
Estimated Cost of Construction: \$120,000.00		CRF's Due: \$		

Building Permit	Construction cost over:	
	Per Additional \$1000:	
	Plus :	
	Scheduled Base Fee:	
	Plan Review Fee:	
	Total:	\$

Electrical Permit	Cost Per:	Quantity:	Subtotal
	Scheduled Base Fee:	\$25.00	
	Meter Loop:	\$10.00	
	For each Circuit:		
	1 Pole	\$5.00	
	2 Pole	\$10.00	
	3 Pole	\$15.00	
	Temporary Service Pole (T-Pole):	\$25.00	
	Temporary Cut In (TCI):	\$25.00	
	Transformer (per KVA):	\$5.00	
Total:	\$		

Plumbing Permit	Cost Per:	Quantity:	Subtotal
	Scheduled Base Fee:	\$25.00	
	Each fixture, floor drain, or trap:	\$3.00	
	Sewer (new, replaced, or repaired)	\$10.00	
Total:	\$		

Gas Permit	Cost Per:	Quantity:	Subtotal
	Scheduled Base Fee:	\$25.00	
	Each fixture outlet:	\$5.00	
Total:	\$		

Mechanical Permit	Cost Per:	Quantity:	Subtotal
	Scheduled Base Fee:	\$25.00	
	Each Cooling Unit ≤ 5 ton:	\$30.00	
	Cooling Units over 5 tons (per Ton):	\$10.00	
	Boilers (per 500K Btu of input):	\$10.00	
Total:	\$		

Total of all permit fees:	\$
---------------------------	----

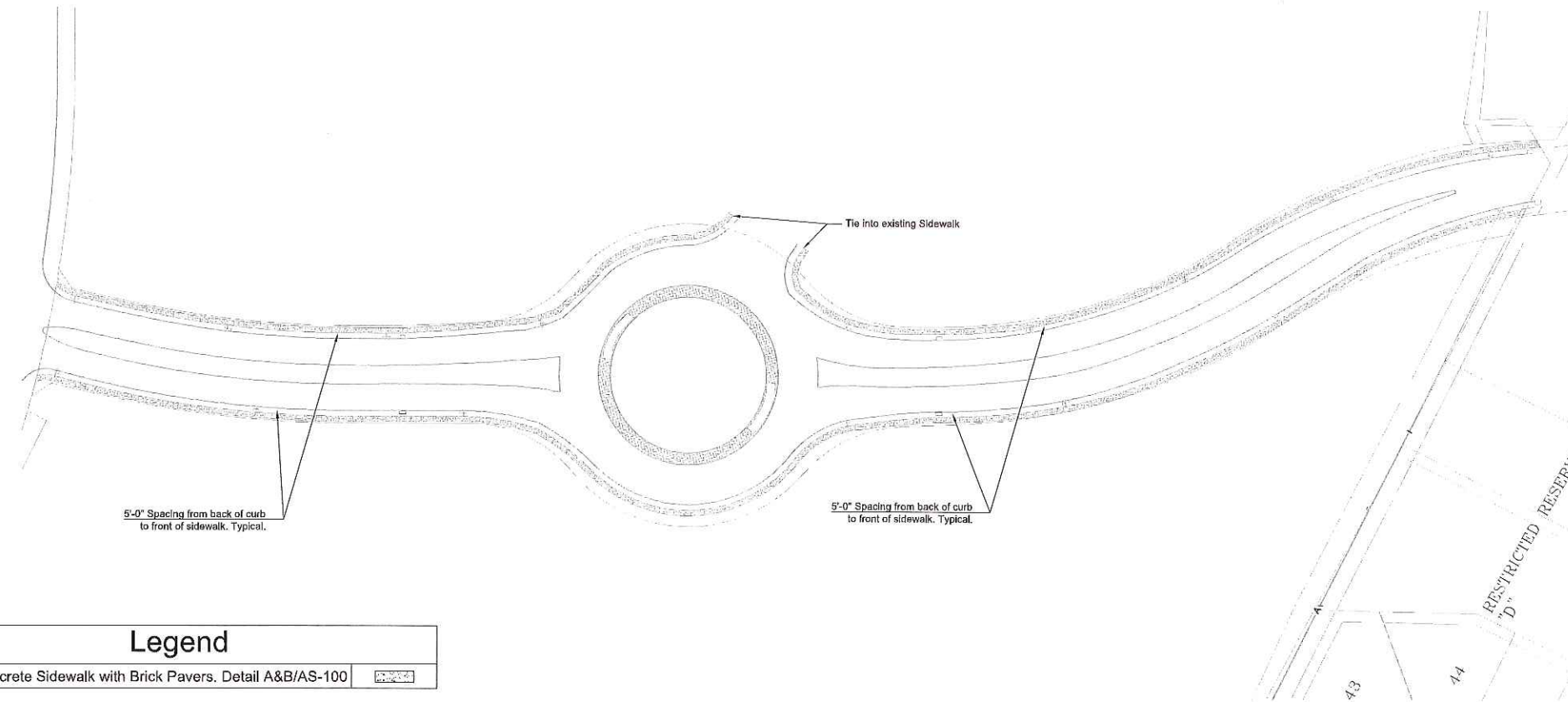

Legend

4 1/2" Concrete Sidewalk with Brick Pavers. Detail A&B/AS-100

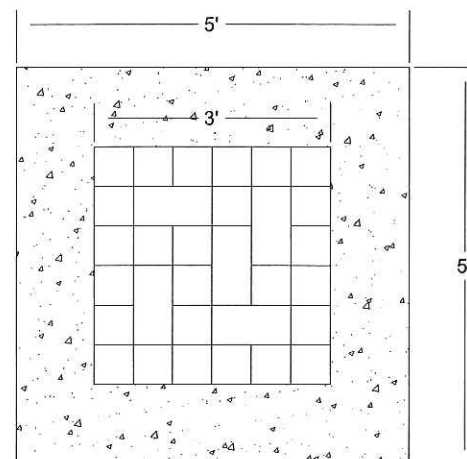

(A) CONCRETE SIDEWALK (DETAIL)
(NTS)

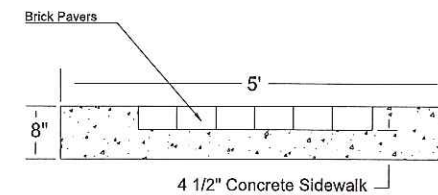

(B) CONCRETE SIDEWALK (DETAIL)
(NTS)

No.	Description	Date

Brookport Drive Improvements

Brookport Drive Sidewalk Site Plans

Project Number: 14A80012
Date: 25 January, 2018
Drawn By: GH
Checked By: JAW

AS-100

Scale: 1" = 40'



City of League City

200

Commercial Permit Application

500 W. Walker St. League City, TX 77573 Phone: 281-554-1429 Fax: 281-554-1460

Project Address:	Pinnacle Park - Brookport Drive	Permit No.:		
	1502 1/2 Brookport Drive		Date:	
	League City, Texas 77573		Fee Due: \$	
Estimated Cost of Construction: \$ 15,000.00		CRF's Due: \$		
Describe work to be done:		Total Permit Fee Cost: \$		
Install landscaping at Brookport ROW		Subtract Plan Review: \$		
(When permit is approved) Final Amount Due: \$				
Legal Description:	Lot:	Block:	Subdivision:	
			Section:	
Type of permit:	BUILDING <input checked="" type="checkbox"/>	MECHANICAL <input type="checkbox"/>	ELECTRICAL <input checked="" type="checkbox"/>	
	PLUMBING <input type="checkbox"/>	GAS <input type="checkbox"/>	OTHER <input type="checkbox"/>	
(Check all that apply.)				
Owner:	General Contractor:			
101 League City I-45/646, L.P.	A-1 Construction Services			
Street: 6108 Brittmoore Road, Suite 200	Street: 6108 Brittmoore Road, Suite 100			
City, State, Zip: Houston, Texas 77041	City, State, Zip: Houston, Texas 77041			
Phone No.: 713-944-2224	Phone No.: 713-975-1819			
E-Mail: jmeador@a1sp.com	E-Mail: jwing@a1sp.com			
Subcontractors:	Company Name	Master's Name		
Electrical:				
Plumbing:				
Mechanical:				
Other:				
Building Information:	Total Area:	Flood Zone:	Base Flood Elevation:	
	Stories:		Finished Floor:	
Type of Construction (IBC Ch 5):			Lowest Adjacent Grade:	
Occupant Load:		Elevation Cert. <input type="checkbox"/>	No Rise Cert. <input type="checkbox"/>	
Provided Documents:	Submit one (1) copy of each (that applies) on a digital CD.			
Survey <input type="checkbox"/>	Plot Plan <input type="checkbox"/>	Energy Cert. <input type="checkbox"/>		
Plumbing / Gas Riser <input type="checkbox"/>	Mechanical Layout <input type="checkbox"/>	Elec. Load Analysis <input type="checkbox"/>		
Construction Plans <input checked="" type="checkbox"/>	Asbestos Survey <input type="checkbox"/>	TDLR # <input type="checkbox"/>		
If not using city service, attach a copy of the approved County Health District permit for this address.				
Private Sewage Permit <input type="checkbox"/>	Well Permit <input type="checkbox"/>	Other <input type="checkbox"/>		
NOTE: Construction or modification of all structures over 250 sq. ft. requires an engineered windstorm design to meet 120 mph, along with foundation and framing plans sealed by an engineer at the time of permit submittal. Upon project completion, proof of TDI Windstorm Certification must be provided to the Building Official for final occupancy to be granted.				
Additional Department / Agency Approvals:		Operations Permit <input type="checkbox"/>		
Development Review DRC <input type="checkbox"/>		Fire Marshal <input type="checkbox"/>		
		Historic District <input type="checkbox"/>		
		County Health District <input type="checkbox"/>		
Additional Comments:				
Storm Water Pollution Prevention Plan (SWPPP) should be in place at all times during construction.				
NOTICE: I HEREBY CERTIFY THAT I HAVE READ AND EXAMINED THIS APPLICATION AND KNOW THE SAME TO BE TRUE AND CORRECT. ALL PROVISIONS OF LAWS AND ORDINANCES GOVERNING THE TYPE OF WORK WILL BE COMPLIED WITH, WHETHER SPECIFIED OR NOT. THE GRANTING OF A PERMIT DOES NOT PRESUME TO GIVE AUTHORITY TO VIOLATE OR CANCEL THE PROVISIONS OF ANY OTHER STATE OR LOCAL LAW REGULATING CONSTRUCTION OR THE PERFORMANCE OF CONSTRUCTION.				
I UNDERSTAND THE LEAGUE CITY CONSTRUCTION TIMES ARE FROM 7:00AM TO 7:00PM AND CITATIONS WILL BE ISSUED IF NOT COMPLIANT.				
APPLICANT'S SIGNATURE				
Printed Name: Justin Wing				
Phone No.: 713-975-1819				
E-Mail: jwing@a1sp.com				
Initial Review				
By:		Date:		
Approved				
By:		Date:		



City of League City

200

Commercial Permit Application

500 W. Walker St. League City, TX 77573 Phone: 281-554-1429 Fax: 281-554-1460

Project Address:	Pinnacle Park - Pinnacle Park Drive	Permit No.:	
	Pinnacle Park Drive @ Brookport Drive	Date:	
	League City, Texas 77573	Fee Due: \$	
Estimated Cost of Construction: \$15,000.00		CRF's Due: \$	

Building Permit	
Construction cost over:	
Per Additional \$1000:	
Plus :	
Scheduled Base Fee:	
Plan Review Fee:	
Total:	\$

Electrical Permit	Cost Per:	Quantity:	Subtotal
Scheduled Base Fee:	\$25.00		
Meter Loop:	\$10.00		
For each Circuit:			
1 Pole	\$5.00		
2 Pole	\$10.00		
3 Pole	\$15.00		
Temporary Service Pole (T-Pole):	\$25.00		
Temporary Cut In (TCI):	\$25.00		
Transformer (per KVA):	\$5.00		
Total:	\$		

Plumbing Permit	Cost Per:	Quantity:	Subtotal
Scheduled Base Fee:	\$25.00		
Each fixture, floor drain, or trap:	\$3.00		
Sewer (new, replaced, or repaired)	\$10.00		
Total:	\$		

Gas Permit	Cost Per:	Quantity:	Subtotal
Scheduled Base Fee:	\$25.00		
Each fixture outlet:	\$5.00		
Total:	\$		

Mechanical Permit	Cost Per:	Quantity:	Subtotal
Scheduled Base Fee:	\$25.00		
Each Cooling Unit ≤ 5 ton:	\$30.00		
Cooling Units over 5 tons (per Ton):	\$10.00		
Boilers (per 500K Btu of input):	\$10.00		
Total:	\$		

Total of all permit fees: \$

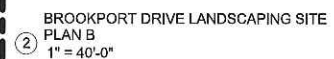
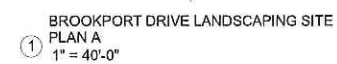

Project number	-
Date	5.26.2015
Drawn by	JAW
Checked by	-
L100	
Scale	1" = 40'-0"



City of League City

400

Irrigation Permit Application

600 W. Walker St. League City, TX 77573 Phone: 281-554-1429 Fax: 281-554-1460

Project Address:	Pinnacle Park - Brookport Drive	Permit No. :		
	1502 1/2 Brookport Drive		Date:	
	League City, TX 77573		Fee Due:	
		CRF's Due:		

Describe work to be done:	Total Cost:			
Irrigation at Brookport Drive				
Legal Description:	Lot:	Block:	Section:	Subdivision:

Owner: 101 League City I-45/646 LP	Irrigation Contractor: A-1 Construction Services
Street: 6108 Brittmoore Road, Suite 200	Street: 6108 Brittmoore Road, Suite 100
City, State, Zip: Houston, Texas 77041	City, State, Zip: Houston, Texas 77041
Phone: 713-944-2224	Phone: 713-975-1819
E-Mail: jmeador@a1sp.com	E-Mail: jwing@a1sp.com

SUB-CONTRACTORS:	Company Name	Master's Name	Registration #
Electrical: MV Electric, Inc.		Clay Fife	177313
Plumbing:			
Other: Montez Irrigation and Landscaping		Juan Montez	N/A

Provided Documents:

Survey ☐ Site Plan ☒ Zone /Head Layout ☒

Flow Calculation ☒ Other ☐

Submit 1 Digital Set

If not using city service, attach a copy of the approved County Health District permit for this address:

Well Permit ☐

Inspection Requirements:

See Irrigation S.O.P. For inspection procedures

Final Inspection : Irrigator or their representative will be on site to operate system at final inspection.

NOTICE: I HEREBY CERTIFY THAT I HAVE READ AND EXAMINED THIS APPLICATION AND KNOW THE SAME TO BE TRUE AND CORRECT. ALL PROVISIONS OF LAWS AND ORDINANCES GOVERNING THE TYPE OF WORK WILL BE COMPLIED WITH, WHETHER SPECIFIED OR NOT. THE GRANTING OF A PERMIT DOES NOT PRESUME TO GIVE AUTHORITY TO VIOLATE OR CANCEL THE PROVISIONS OF ANY OTHER STATE OR LOCAL LAW REGULATING CONSTRUCTION OR THE PERFORMANCE OF CONSTRUCTION.

APPLICANT'S SIGNATURE

Printed Name: Justin Wing

Phone No : 713-975-1819

Fax No: 713-975-9158

E-Mail: jwing@a1sp.com

Irrigation Permit		Cost Per:	Quantity:	Sub. Total
Scheduled Base Fee:	\$25.00	1		\$25.00
Backflow Preventer:	\$25.00	1		\$25.00
Sprinkler Head:	\$0.50	196		\$98.00
Valves:	\$3.00	9		\$27.00
				Total: \$175.00

Additional Comments:

Initial Review	
By:	Date:
Approved	
By:	Date:

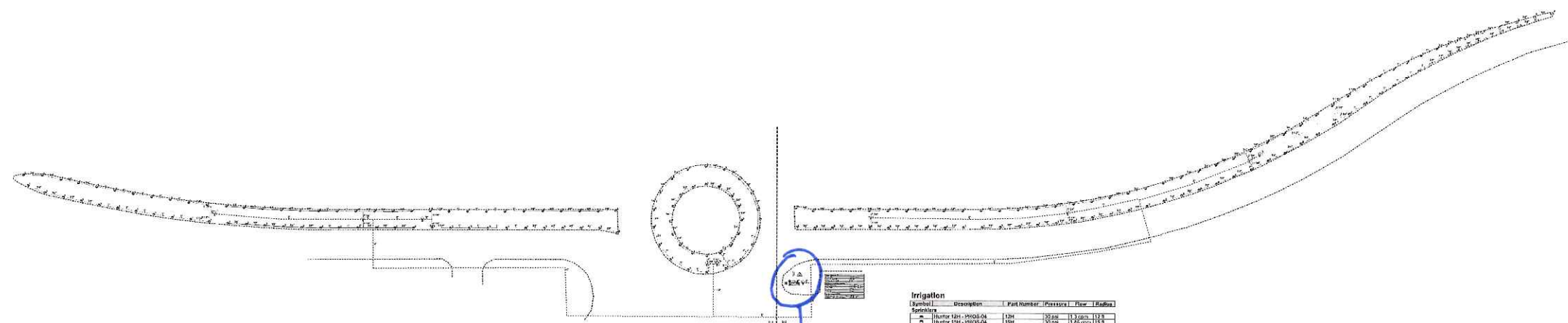

Is Controller double check Line of Sight Req.

Symbol	Description	Part Number	Pressure	Flow	Radius
1	Hunter 1/2" - PHOS-04	1/2"	30 psi	1.3 gpm	112.8'
2	Hunter 1/2" - PHOS-04	1/2"	30 psi	1.3 gpm	112.8'
3	Hunter 1/2" - PHOS-04	1/2"	30 psi	1.3 gpm	112.8'
4	Hunter 1/2" - PHOS-04	1/2"	30 psi	1.3 gpm	112.8'
5	Hunter 1/2" - PHOS-04	1/2"	30 psi	1.3 gpm	112.8'
6	Hunter 1/2" - PHOS-04	1/2"	30 psi	1.3 gpm	112.8'
7	Hunter 1/2" - PHOS-04	1/2"	30 psi	1.3 gpm	112.8'
8	Hunter 1/2" - PHOS-04	1/2"	30 psi	1.3 gpm	112.8'
9	Hunter 1/2" - PHOS-04	1/2"	30 psi	1.3 gpm	112.8'
10	Hunter 1/2" - PHOS-04	1/2"	30 psi	1.3 gpm	112.8'
11	Hunter 1/2" - PHOS-04	1/2"	30 psi	1.3 gpm	112.8'
12	Hunter 1/2" - PHOS-04	1/2"	30 psi	1.3 gpm	112.8'
13	Hunter 1/2" - PHOS-04	1/2"	30 psi	1.3 gpm	112.8'
14	Hunter 1/2" - PHOS-04	1/2"	30 psi	1.3 gpm	112.8'
15	Hunter 1/2" - PHOS-04	1/2"	30 psi	1.3 gpm	112.8'
16	Hunter 1/2" - PHOS-04	1/2"	30 psi	1.3 gpm	112.8'
17	Hunter 1/2" - PHOS-04	1/2"	30 psi	1.3 gpm	112.8'
18	Hunter 1/2" - PHOS-04	1/2"	30 psi	1.3 gpm	112.8'
19	Hunter 1/2" - PHOS-04	1/2"	30 psi	1.3 gpm	112.8'
20	Hunter 1/2" - PHOS-04	1/2"	30 psi	1.3 gpm	112.8'

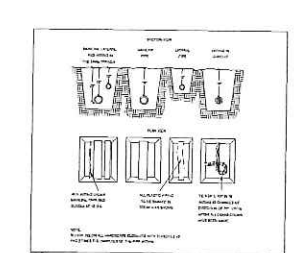
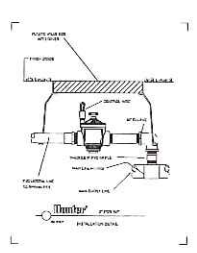
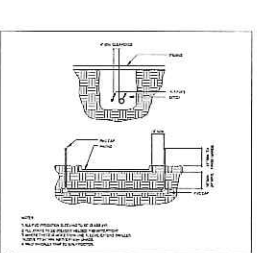
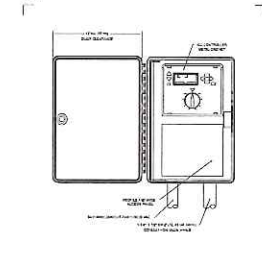
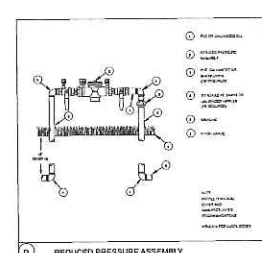
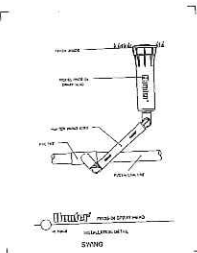

CJS Yardworks
1443 Katyflewellen Rd
Katy, Texas 77494

SHEET DESCRIPTION:
Irrigation

PROJECT:
Brookport Road
League City

REVISIONS:
None

DATE:
1/31/2015
JOB NUMBER:
1312015
DRAWN BY:
Robert Proske
CHECKED BY:
CRP

SCALE:
1" = 50'

SHEET:
1 of 3

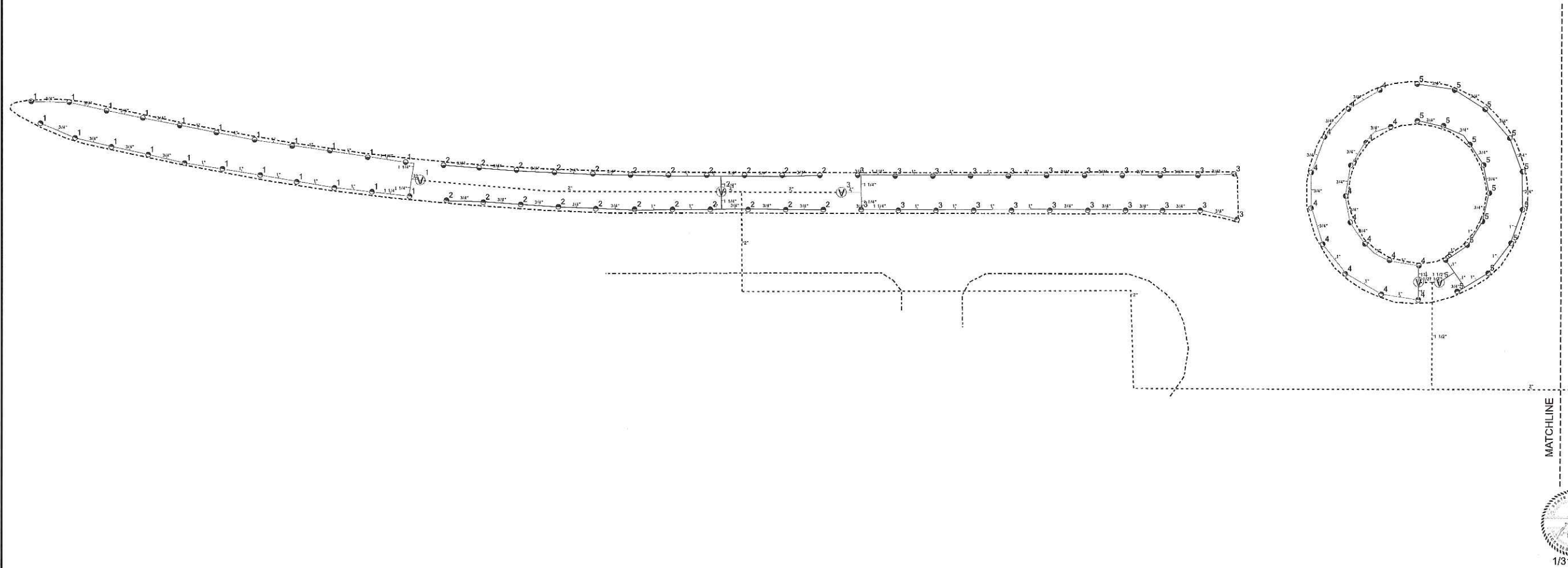

MATCHLINE



CJ'S Yardworks
1443 Katyfleweller Rd
Katy, Texas 77494

SHEET DESCRIPTION:
Irrigation 2

PROJECT:
Brookport Point
League City

REVISIONS:
None

DATE:
1/31/2015

JOB NUMBER:
1312015

DRAWN BY:
Robert Proske

CHECKED BY:
CRP

SCALE:
1" = 20'

SHEET:
2 of 3

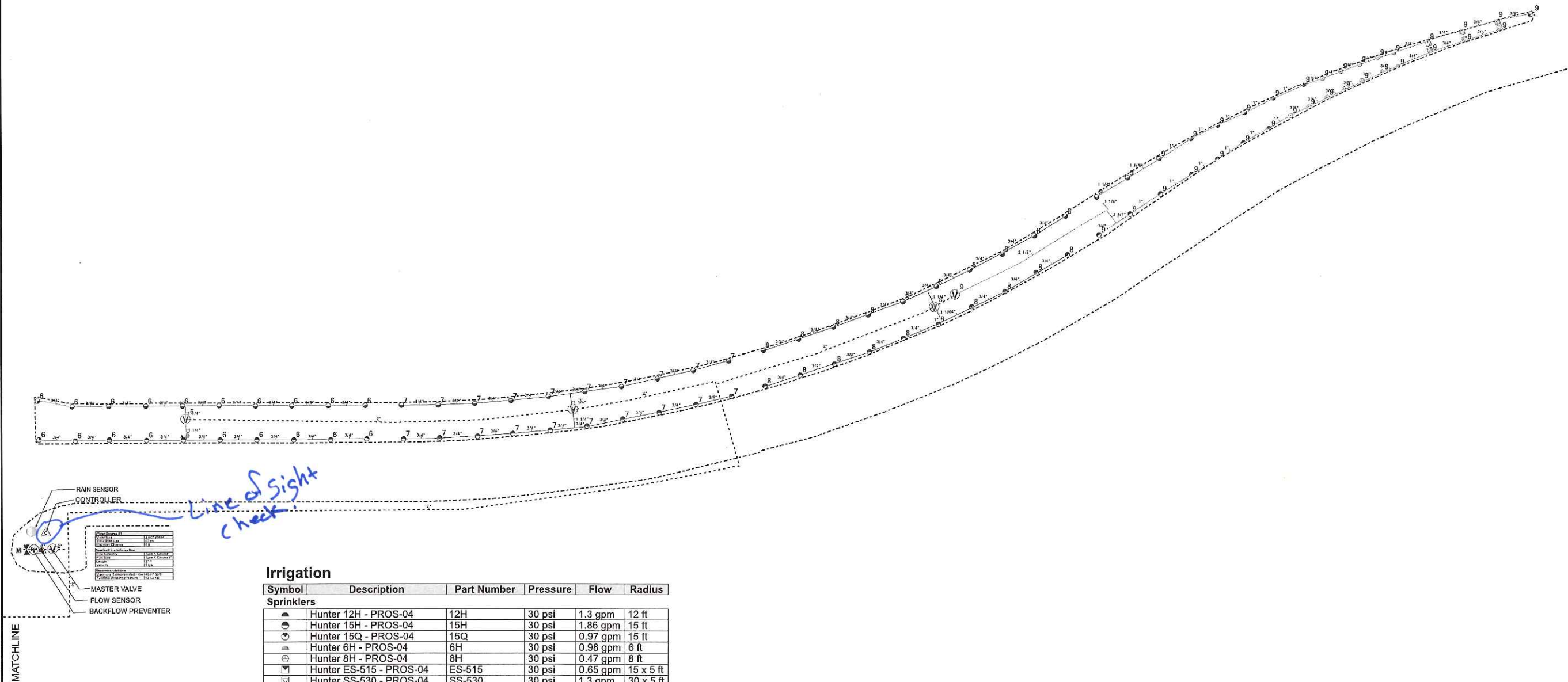

Irrigation

Symbol	Description	Part Number	Pressure	Flow	Radius
Sprinklers					
☼	Hunter 12H - PROS-04	12H	30 psi	1.3 gpm	12 ft
☼	Hunter 15H - PROS-04	15H	30 psi	1.86 gpm	15 ft
☼	Hunter 15Q - PROS-04	15Q	30 psi	0.97 gpm	15 ft
☼	Hunter 6H - PROS-04	6H	30 psi	0.98 gpm	6 ft
☼	Hunter 8H - PROS-04	8H	30 psi	0.47 gpm	8 ft
☼	Hunter ES-515 - PROS-04	ES-515	30 psi	0.65 gpm	15 x 5 ft
☼	Hunter SS-530 - PROS-04	SS-530	30 psi	1.3 gpm	30 x 5 ft

Meters/Pumps

☼	2 inch meter	
---	--------------	--

Backflow Devices

☼	Febco 860 - 2"	860 - 2"
---	----------------	----------

Control Valves

☼	Hunter PGV-201 Globe	PGV-201 Globe
---	----------------------	---------------

Irrigation Accessories

☼	Hunter 21/2 inch flowmeter	
☼	Hunter IC-1200-PP	IC-1200-PP
☼	Hunter Wireless Solar Sync	WSS
☼	Spears 2" Gray PVC - Socket	2621-020G

Lateral Line Pipe

☼	Class 200 3/4"	
☼	Class 200 1"	
☼	Class 200 1 1/4"	
☼	Class 200 1 1/2"	
☼	Class 200 2"	
☼	Class 200 2 1/2"	

Mainline Pipe

☼	Schedule 40 1 1/2"	
☼	Schedule 40 2"	



1/31/2015

CJ'S Yardworks
1443 Katyflewellen Rd
Katy, Texas 77494

SHEET DESCRIPTION:
Irrigation 1

PROJECT:
Brookport Point
League City

REVISIONS:
None

DATE:
1/31/2015

JOB NUMBER:
1312015

DRAWN BY:
Ronert Proske

CHECKED BY:
CRP

SCALE:
1" = 20'

SHEET:
3 of 3