

FND 1"=1.P.

BLOCK 253

FND 1/2"=1.R.



SCALE: 1"=60'

19th STREET

(70' R.O.W.)

N 50°51'00" E 260.00'

SET PIN W/CAP
STAMPED DL HARDY
RPLS 4847

SET PIN W/CAP
STAMPED DL HARDY
RPLS 4847

KENTUCKY AVENUE NOT OPEN
(70' R.O.W.)

N 39°09'00" W 300.00'

S 39°09'00" E 300.00'

WYOMING AVENUE
(70' R.O.W.)

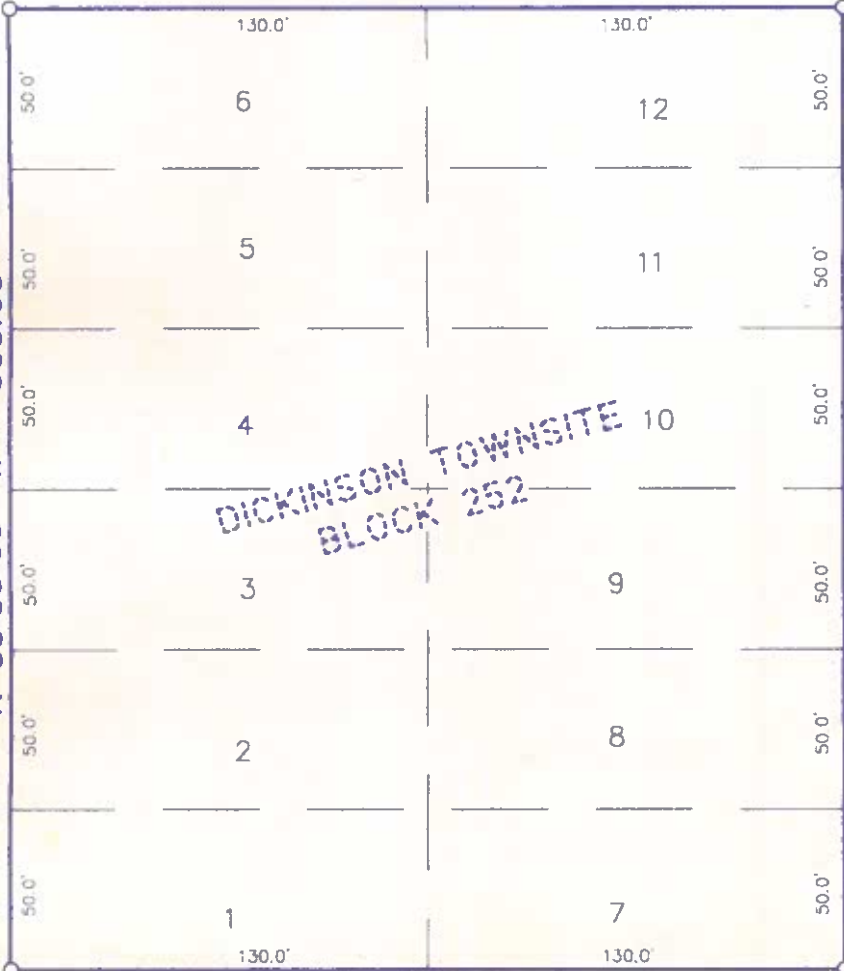

DICKINSON TOWNSITE
BLOCK 252

S 50°51'00" W 260.00'

20th STREET

(70' R.O.W.)

SET PIN W/CAP
STAMPED DL HARDY
RPLS 4847

SET PIN W/CAP
STAMPED DL HARDY
RPLS 4847

SET PIN W/CAP
STAMPED DL HARDY
RPLS 4847

N 50°51'00" E 260.00'

KENTUCKY AVENUE NOT OPEN
(70' R.O.W.)

N 39°09'00" W 300.00'

SET PIN W/CAP
STAMPED DL HARDY
RPLS 4847

S 39°09'00" E 300.00'

WYOMING AVENUE
(70' R.O.W.)

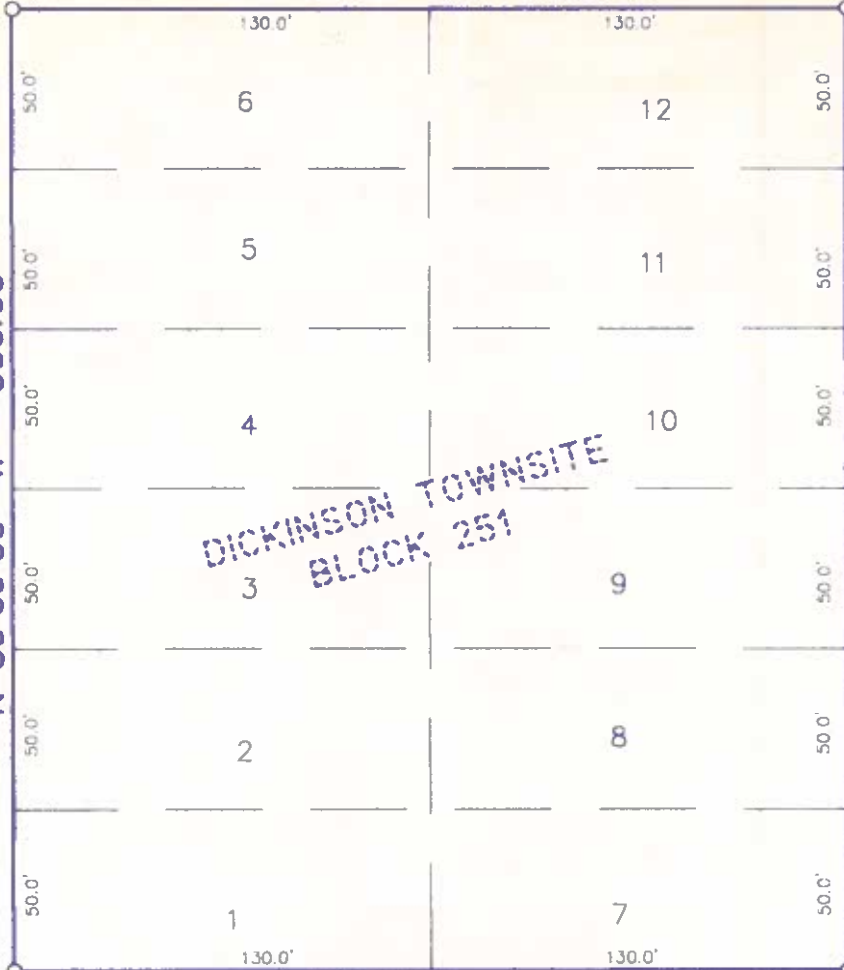

DICKINSON TOWNSITE
BLOCK 251

S 50°51'00" W 260.00'

21st STREET NOT OPEN

(70' R.O.W.)

SET PIN W/CAP
STAMPED DL HARDY
RPLS 4847

SET PIN W/CAP
STAMPED DL HARDY
RPLS 4847

BLOCK 250

June 18, 2000

Survey of All of Blocks Two Hundred Fifty-one (251) and Two Hundred Fifty-two (252), of **DICKINSON TOWNSITE**, a Subdivision in Galveston County, Texas, according to the map or plat thereof recorded in Volume 155, Page 10, of the Map Records in the Office of the County Clerk of Galveston County, Texas.

I hereby certify that on the above date, the herein described Lots were surveyed on the ground and under my direction, and that this map, together with dimensions as shown hereon, accurately represents the facts as found on the ground this date.



DALE L. HARDY & Associates

Dale L. Hardy
Registered Professional
Land Surveyor 4847

Borrower: Robert K. Parks and Cassandra Dyson

Notes: This property does not lie within the 100 Year Flood Plain as determined by FEMA and as shown on FIRM 485470, 0095 C, Zone C, dated May 2, 1983.

This survey has been prepared based on Title Commitment provided by Stewart Title Company, G.F. #00207250, dated June 6, 2000.

DALE L. HARDY
AND ASSOCIATES

REGISTERED PROFESSIONAL LAND SURVEYORS

P.O. BOX 846, LEAGUE CITY, TEXAS 77574
281-554-7739 409-785-8030 FAX: 281-554-8828